

Job Name: \_\_\_\_\_

Type: \_\_\_\_\_

Order Number: \_\_\_\_\_

# Mounting Adaptors

## — 00 LSI Track Adaptor

Low profile Lexan adaptor for 1 and 2 circuit LSI Track. Integral on/off switch and mechanical safety interlock for positive nonenergized making and breaking of fixture contacts with track. Available in Black (RAL #9005), White (RAL #9010), and Platinum Lexan to match fixture housings and track.

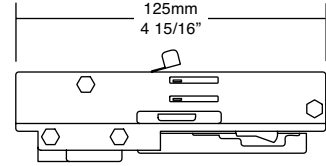
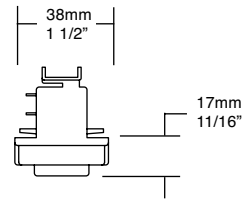

CE Certified

## — 2G Universal Flange Adaptor

2-hole flanged steel plate for any screw or bolt-up application. Integral on/off switch and 2500mm cord and plug. Available in Black (RAL #9005), White (RAL #9010), and Platinum paint finish to match fixture housings. White finish supplied with white cord, all other finishes supplied with black cord.

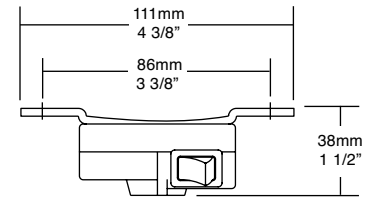
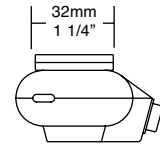

CE Certified

## — 3G C-Clamp Adaptor

Extruded Aluminium C-Clamp for pipes from 16mm to 50mm O.D. Integral on/off switch and 2500mm cord and plug. Available in Black (RAL #9005), White (RAL #9010), and Platinum paint finish to match fixture housings. White finish supplied with white cord, all other finishes supplied with black cord.

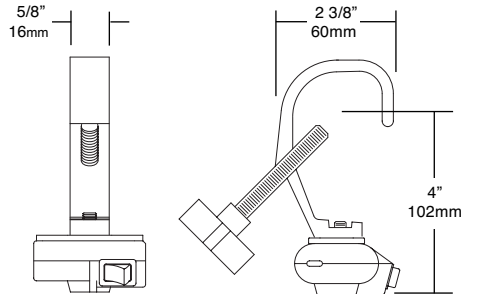

CE Certified

## — 5 Canopy Adaptor

24mm deep by 127mm diameter Surface mounting plate with terminal block for mains connection. Fixture supplied with 150mm high temperature leads ready for splicing. Available in Black (RAL #9005), White (RAL #9010), and Platinum paint finish to match fixture housings.

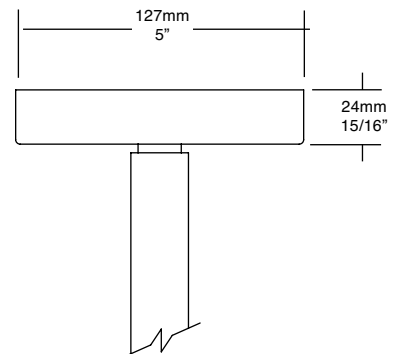

## — 5E Canopy Fitting

Same as above with integral transformer for certain low voltage fixtures. See specific catalog sheets.

CE Certified

© 1982 Lighting Services Inc

Job Name:

Type:

Order Number:

# Mounting Adaptors

— **NA Nashop Track Fitting**

32mm diameter track fitting for Nashop track systems. Available in Black and White finishes.

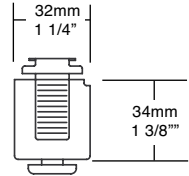

CE Certified