

LUMELX® 2044 SERIES 120/277V • LUMENETIX • 19MM



Elegant fixture designed specifically for the most demanding architecture applications.

- Designed for the Lumenetix Arraya Color Tuning LED module up to 20 Watts
- Extremely tight color consistency (less than 2 MacAdam Ellipses, ± 0.002 DUV)
- System efficiency up to 42 lumens/watt
- On board closed loop feedback compensates each channel for thermal and optical depreciation.
- 50,000 hour life to 70% lumen output, L70 at 95°F max ambient
- Tunable white from 1650K to 8000K
- Full color tuning and gradients of saturated colors
- Color Rendering Index (CRI) of 90+ from 2000K to 6000K
- 1000 produced lumens
- Tested to LM79 and LM80 Protocols
- Choice of dimming down to 1%
- Compatible with 0-10V, DMX, RDM, Bluetooth via IOS app and on-board dimming
- SceneSet enables recall of up to 5 scenes using 0-10V or on-board dimmers
- Field interchangeable optics (15°- 60°) modify the beam spread distribution
- Accessory holder accepts up to two size-AA LSI filters and accessories
- Integral dimmer available
- Finishes: LSI Black, White, and Silver
- Fixture weight: 3 lbs
- All modules are field replaceable

MOUNTING OPTIONS

Please review the **ORDERING INFORMATION** section on the next page on how to specify the following:

- | | | |
|---------------------|---------------|-----------|
| • LED Module | • Optic - mm/ | • Voltage |
| • LED Rating | beam spread | • Finish |
| • Color Temperature | • Dimming | |

LX2044-XXXXX-XXXXXX-00-BTXXXX

Lexan fitting for 1 and 2 circuit LSI track. With On/Off switch.

LX2044-XXXXX-XXXXXX-CT1-DXXXXX

Lexan fitting for 1 and 2 circuit LSI CONTROLTrack. With On/Off switch.

LX2044-XXXXX-XXXXXX-CT1-10XXXX

Lexan fitting for 1 and 2 circuit LSI CONTROLTrack. With On/Off switch.

LX2044-XXXXX-XXXXXX-0E-EDXXXX

Lexan fitting with integral dimmer (for use with ED dimming driver 10%).

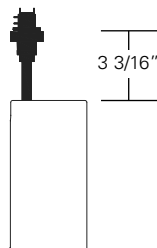

LX2044-XXXXX-XXXXXX-5A-XXXXXX

Canopy for permanent mounting on standard 4" octagonal junction boxes.

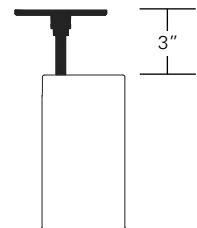

Other Options (Consult Factory):

- Custom Stems, specify length (4" - 48")
- Custom color, RAL palette
- Security/Worklite Fixture, use **-EF** as mounting option. (track mount only)

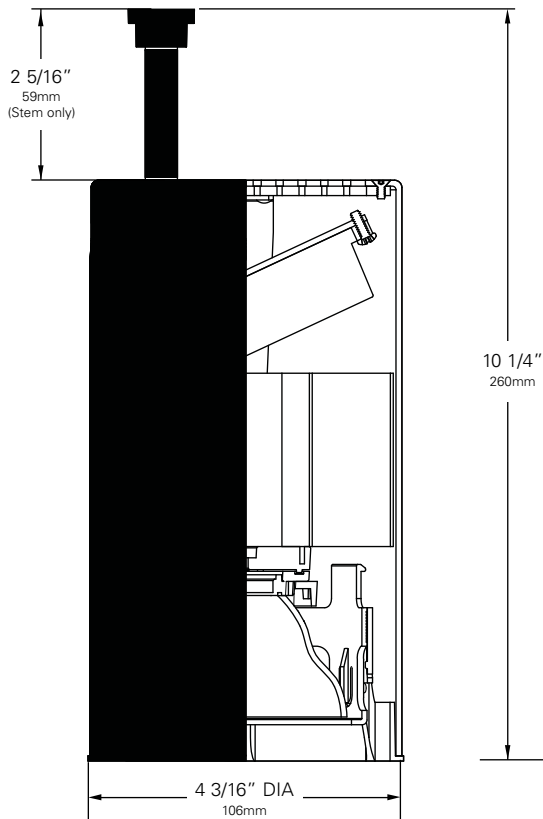

ORDERING INFORMATION

Lumenetix 19mm Fixture

1. Choose the desired LED Module (**L19**) for Lumenetix (19mm)
2. Choose the numeric code to designate the desired LED Rating
Lumens/CRI/Wattage
(10-90) for 1000/90/20
3. Choose the numeric code to designate the desired **Color Temperature**
(LW) for Dynamic White **(LC)** for Full Color
4. Use the following alpha-numeric code to designate the **Optic**
(S1) for 50mm/15°
(WR) for 70mm/20°(Field Reducer)
(M2) for 70mm/20° (Narrow Field Angle)
(M9) for 70mm/20° (Wide Field Angle)
(M4) for 70mm/35° (Narrow Field Angle)
(M8) for 70mm/40° (Wide Field Angle)
(M6) for 70mm/60°
5. Select your **Mounting Option**
(00) Track Fitting **(0E)** Track Fitting with Integral Dimmer
(CT1) CONTROLTrack Fitting **(5A)** Canopy Fitting
6. Choose the letter code for **Dimming Type:**
(DX) DMX/RDM (CT1 only)
(ED) Integral Dimming (1%) (0E & 5A fitting only, LW only)
(BT) Bluetooth (IOS)
(10) 0-10V (1%) (CT1 & 5A fitting only, LW only)
7. Choose the desired **Voltage:**
(120) for 120V **(230)** for 220-240V **(277)** for 277V
8. Choose a **Finish** for your fixture: Black (**B**) White (**W**) Silver (**S**)

Example: **LX2044 - L19 10-90 LC S1 - CT1 - DX 120 B**

FIXTURE LED MODULE LED RATING COLOR TEMP OPTIC FITTING DIMMING VOLTAGE FINISH

9. Don't forget your Accessories!

ACCESSORIES

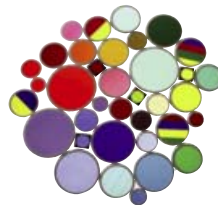

Glass Color Filters AA

As the foremost innovator in accent lighting, LSI offers a complete range of permanent fade-free glass color filters, which are available in nine stock diameters.

- **ANG Hood 2IN AA**
- **Hood 2IN AA**

Other accessories:

- **LX-S15-REF-B (50mm/15°)**
- **LX-WRD-REF-CLR (70mm/20°)**
- **LX-M20-REF-B (70mm/20°)**
- **LX-M90-REF-CLR (70mm/20°)**
- **LX-M40-REF-B (70mm/35°)**
- **LX-M80-REF-CLR (70mm/40°)**
- **LX-M60-REF-CLR (70mm/60°)**
- **Color and Spread Gels AA**
- **Backer Ring AAB**
- **Louver Hex AA**
- **Beam Softener AA998**
- **Lighting Blocking Screens AA801S, AA802S, AA803S**
- **Spread Lenses AA990, AA992, AA995, AA996**

LUMELIX® 2044 SERIES • LUMENETIX 19MM PERFORMANCE

The performance characteristics of the LumELIX family of products can be customized based on the LED module and the optic (reflector) selected.

Each available LED module is defined by four characteristics – module type (dynamic white vs full color), control type (0-10V, DMX, Bluetooth), the power that it uses (watts), and its “available lumens.” Note that available lumens is a theoretical value that represents the light output of the module on its own – no fixture or optic attached.

In the LSI part number, the LED module is specified with a letter and a number that immediately follow the product series number. For example, in the part number LX2044-L1910-90LCS1-CT1-DX120B, the “**L1910-90LC**” represents a 19mm Lumenetix module with an output of 1000 Lumens, a minimum CRI of 90, with full color tuning and power usage of 20 Watts.

The available optics (reflectors) are characterized by size, beam angle, and in some cases the characteristics of the field angle (narrow or wide). The optic is specified by the two characters that follow the LED designation in the part number. For example, the “**S1**” in LX2044-L1910-90LCS1-CT1-DX120B is a 50mm diameter optic that has a 15-Degree beam with a narrow field.

Additional parameters, such as Center Beam Candle Power (CBCP), Delivered Lumens, and Efficiency (Lumens per Watt) are all shown in a table that is organized by LED module and optic combination.

CBCP = Center Beam Candle Power

LED Module	Optic (Reflector)						
Lumens/CRI/Wattage	S1	M2	WR	M4	M6	M8	M9
1000/90/20	2,870	3,270	2,490	2,180	980	1,480	3,000

Delivered Lumens

LED Module	Optic (Reflector)						
Lumens/CRI/Wattage	S1	M2	WR	M4	M6	M8	M9
1000/90/20	310	390	220	580	720	830	830

Efficiency = Lumens Per Watt

LED Module	Optic (Reflector)						
Lumens/CRI/Wattage	S1	M2	WR	M4	M6	M8	M9
1000/90/20	16	20	11	29	36	42	42

Absolute range of values are +/- 10% of typical value, and are for all color temperatures

LED Module Lumens/CRI/Wattage Letter Code	1000/90/20 10-90
Nominal Fixture Power (+/- 20%), Watts	20
Maximum Inrush Current, Amps	10
Minimum Power Factor	0.92

Inrush current is instantaneous current drawn by the LED only when fixture is initially powered on or instantaneously changed from full dim to full bright. For more details see Dimming Application Sheet, IS-0119.

LUMeLEX® 2044 SERIES • LUMENETIX 19MM OPTICS

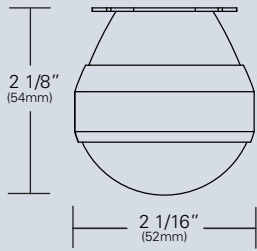

LX-S15-REF-B (S1)
(50mm/15°)

Anti-reflective coated aspheric lens. Tool-less, twist and lock installation. Black finish.

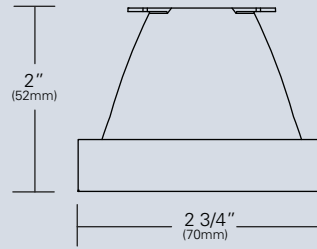

LX-WRD-REF-CLR (WR)
(70mm/20°)

Field reducer. Proprietary field reducing baffle. Clear finish.

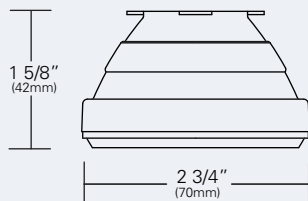

LX-M20-REF-B (M2)
(70mm/20°)
(Narrow Field Angle)

Computer designed polycarbonate lens. Tool-less, twist and lock installation. Black finish.

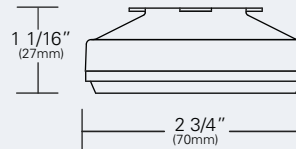

LX-M40-REF-B (M4)
(70mm/35°)
(Narrow Field Angle)

Computer designed polycarbonate specular optic. Tool-less, twist and lock installation. Black finish.

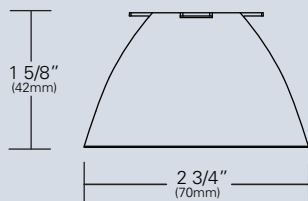

LX-M90-REF-CLR (M9)
(70mm/20°)
(Wide Field Angle)

Computer designed polycarbonate specular optic. Tool-less, twist and lock installation. Clear finish.

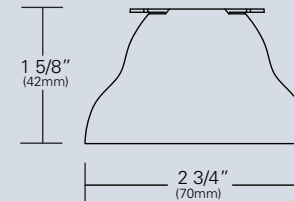

LX-M80-REF-CLR (M8)
(70mm/40°)
(Wide Field Angle)

Computer designed polycarbonate specular optic. Tool-less, twist and lock installation. Clear finish.

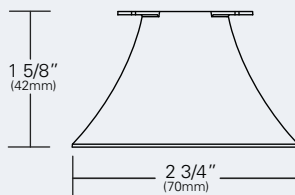

LX-M60-REF-CLR (M6)
(70mm/60°)

Computer designed polycarbonate specular optic. Tool-less, twist and lock installation. Clear finish.

LUMeLEX 2044 • ACCESSORIES

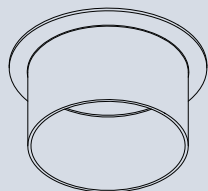

HOOD 2IN AA

2 inch deep hood

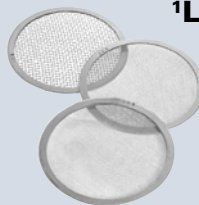

¹LIGHT BLOCKING SCREENS AA

Stainless steel mesh screens used alone or in combinations will block from approximately 20% to 90% of the transmitted light without changing color temperature of the light

No.	% of Light Blocked
AA801S	20
AA802S	30
AA803S	40

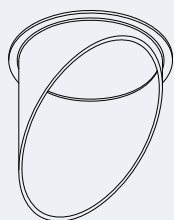

ANG HOOD 2IN AA

2 inch deep angled hood

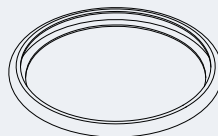

BACKER RING AA

Stainless steel ring to hold gel when no other size AA accessories is being used.



SPREAD LENSES AND BEAM SOFTENER

No.	Description	% of Light Transmission
990	Spread Lens/Clear	83 (5°X 50°)
992	Spread Lens/Clear	85 (5°X 30°)
995	Spread Lens/Clear	83 (50°X 50°)
996	Spread Lens/Clear	86 (45°X 50°)
998	Beam Softener/Clear	80 (45°X 45°)

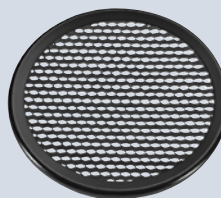

LOUVER HEX AA

1/8" thick Hexcell black metal louver used for thin profile.

1. Figures vary based upon LED Module/Optic being used and relationship of screen(s) to LED Module/Optic and to each other.

LUMeLEX® 2044 SERIES • GELS

As the foremost innovator in accent lighting, LSI offers a complete range of pre-cut Gels to modify the spread and color of light for the LumeLEX LED Series.



LumeLEX® SPREAD GELS

Size: AA (76 mm diameter)	Spread Gel
GEL-L1-AA	1° Spread Gel
GEL-L5-AA	5° Spread Gel
GEL-L10-AA	10° Spread Gel
GEL-L20-AA	20° Spread Gel
GEL-L30-AA	30° Spread Gel
GEL-L40-AA	40° Spread Gel
GEL-L60-AA	60° Spread Gel
GEL-L80-AA	80° Spread Gel
GEL-L30B5-AA	30° by 5° Spread Gel
GEL-L40B2-AA	40° by 0.2° Spread Gel
GEL-L60B1-AA	60° by 1° Spread Gel
GEL-L60B10-AA	60° by 10° Spread Gel
GEL-L75B45-AA	75° by 45° Spread Gel
GEL-L90B60-AA	90° by 60° Spread Gel
GEL-R101-AA	Beam Softener

LumeLEX® COLOR GELS

Size: AA (76 mm diameter)	Gel Color	Size: AA (76 mm diameter)	Gel Color
GEL-R2-AA	Bastard Amber	GEL-R312-AA	Canary
GEL-R7-AA	Pale Yellow	GEL-R3204-AA	Half Blue
GEL-R12-AA	Straw	GEL-R331-AA	Shell Pink
GEL-R13-AA	Straw Tint	GEL-R383-AA	Sapphire Blue
GEL-R14-AA	Medium Straw	GEL-R397-AA	Pale Grey
GEL-R21-AA	Golden Amber	GEL-R2001-AA	Storaro Red
GEL-R25-AA	Orange Red	GEL-R2004-AA	Storaro Green
GEL-R26-AA	Light Red	GEL-R2009-AA	Storaro Violet
GEL-R27-AA	Medium Red	GEL-R3202-AA	Full Blue
GEL-R57-AA	Lavender	GEL-R3206-AA	Third Blue
GEL-R62-AA	Booster Blue	GEL-R3216-AA	Eighth Blue (Boosts 3200K to 3300K)
GEL-R71-AA	Sea Blue	GEL-R3318-AA	Tough 1/8 Minusgreen
GEL-R72-AA	Azure Blue	GEL-R3410-AA	Roscosun (1/8 CTO) (Reduces 5500K to 4900K)
GEL-R91-AA	Primary Green	GEL-R3441-AA	Full Straw (CTS)
GEL-R97-AA	Light Grey	GEL-R3443-AA	Quarter Straw (CTS)
GEL-R98-AA	Medium Grey	GEL-R4330-AA	CalColor 30 Cyan
GEL-R101-AA	Light Frost	GEL-R4415-AA	CalColor 15 Green
GEL-R104-AA	Tough Silk	GEL-R4490-AA	CalColor 90 Green
GEL-R119-AA	Light Hamburg Frost	GEL-R4860-AA	CalColor 60 Pink
GEL-R121-AA	Blue Diffusion	GEL-R4890-AA	CalColor 90 Pink
GEL-R305-AA	Rose Gold	GEL-R4930-AA	CalColor 30 Lavender

* Backer Ring AAB required to hold gels when no other rimmed "AA" accessories are used.

COLOR MEDIA

COLOR FILTERS

As the foremost innovator in accent lighting, LSI offers a complete range of permanent fade-free glass color filters, which are available in nine stock diameters. All glass color filters are rimmed in a seamless aluminum ring and are slotted for heat expansion.

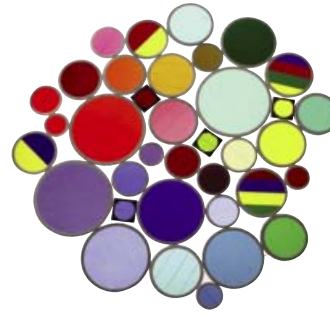

Size	Diameter	LSI Fixture Series	Special Glass Color Filters	No.	Color	% of Light Transmission
AAA	2 3/8"	LumeLEX® 2020/2030/2031/2038, SSLCX16, SSL260, LumeLEX MAR-S	Special Glass Color Filters LSI will fabricate, on special order, glass color filters in most sizes and shapes. FS4 – Color Filter Samples To facilitate selection of glass color filters, LSI supplies a complete set of 1 3/4" X 1 3/4" labeled glass and dichroic samples in a handy carrying case.	902	Medium Pink	36
				903	Deep Pink	37
				904	Flesh Pink	73
				906	Pale Lavender	14
				907	Surprise Pink	19
AA	3"	LumeLEX® 2024 (with LX2024-Holder or LX2024-Barndoor), LumeLEX® 2026, LumeLEX® 2044, LumeLEX 2048		908	Lilac	21
			910	Warm Red	10	
			911	Strawberry	6	
			912	Ruby	4	
			913	Magenta	1	
			914	Light Amethyst	25	
			915	Medium Amethyst	16	
			916	Deep Amethyst	4	
A	3 1/2"	LumeLEX® 2060, SSL230, SSLCX30, SSLGR30CL, SSLGR36		917	Olive	18
			918	Light Green	68	
			920	Medium Green	25	
			921	Deep Green	7	
			922	Silver green	65	
			923	Yellow Green	49	
			924	Emerald Green	12	
			925	Light Turquoise	68	
			926	Medium Turquoise	40	
			927	Deep Turquoise	17	
			928	Light Blue	34	
			930	Medium Blue	3	
			932	Daylight	59	
			933	Gene Moore Blue	18	
			936	Grey	56	
			937	Light Blue Green	17	
			939	Light Amber	68	
			940	Medium Amber	48	
			941	Deep Amber	43	
			942	Straw	78	
			943	Gold	87	
			944	Canary Yellow	84	
			945	Lemon	81	
			946	Pumpkin	32	
			947	Tangerine	20	
			948	Orange	23	
			949	Pink Gold	54	
			950	Bronze	48	
			951	Brass	11	
			952	Autumn Tan	11	
			953	Leaf Brown	19	
			954	Butter Pecan	3	
			955	Toasted Almond	1	

Notes:

1. Values given are approximate due to slight variations in glass color and thickness.

COLOR MEDIA

DICHROIC COLOR FILTERS

In addition to our complete line of glass color filters, LSI now offers dichroic glass color filters that achieve purer, more saturated, richer color by selective wavelength transmission. Since these filters reflect rather than absorb the unwanted color wavelengths, a higher intensity of colored light can be obtained with fewer or lower wattage fixtures. In addition, this selective transmission allows for very accurate color matching from filter to filter.

All standard LSI filter sizes are available in a wide palette of well chosen dichroic colors that can be used with all LSI fixtures that accept accessories.

LSI dichroic glass color filters have the added benefit of being rimmed for extra durability to allow for frequent usage without fear of breakage or edge chipping.

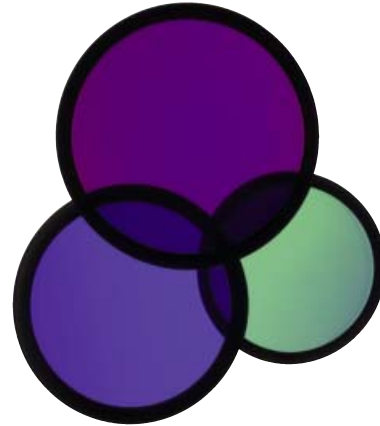

Size	Diameter	LSI Fixture Series	Technical Data	No.	Color	% of Light Transmission
AAA	2 3/8"	LumeLEX® 2020/2030/2031/2038, SSLCX16, SSL260, LumeLEX MAR-S	Dichroic color filters are created in a vacuum chamber by multi-layer vapor deposits of different minerals onto low expansion, chemically resistant Borosilicate glass.	2001	Light Pink	69
AA	3"	LumeLEX® 2024 (with LX2024-Holder or LX2024-Barndoor), LumeLEX® 2026, LumeLEX® 2044, LumeLEX 2048	Deposits are made in alternating layers of varying microscopic thickness which allow very narrow color wavelengths to be selectively transmitted and all other wavelengths to be reflected.	2002	Medium Pink	43
A	3 1/2"	LumeLEX® 2060, SSL230, SSLCX30, SSLGR30CL, SSLGR36	LSI does not recommend using dichroic color filters with lamps or fixtures that have beam spreads greater than 40° because a secondary color aura is created by the wide angular transmitted wavelengths that are different than the desired color wavelength.	2003	Hot Pink	11
B	4 1/4"	LumeLEX® MAR-L	Since there is mainly transmission and reflection of the color wavelengths by the dichroic filter and very little absorption, the dichroic filter can be used with many high temperature lights that normally would not accept color filters.	2004	Pale Pink	55
C	4 3/4"	LumeLEX® 2084, LumeLEX® 2088, SSL238, SSLCX36, SSLCX38, SSLGR38CL		2010	Deep Magenta	29
				2011	Lavender	24
				2012	Vivid Magenta	31
				2013	Lavender Accent	48
				2014	Lilac	37
				2015	Purple Fusion	12
				2020	Sky Blue	39
				2021	Sea Blue	39
				2022	Cyan	33
				2023	Light Blue Green	30
				2024	Primary Blue	24
				2025	Medium Red Blue	15
				2026	Deep Purple	16
				2027	Peacock Blue	53
				2028	Mediterranean Blue	20
				2029	Boost Blue	51
				2040	Light Yellow Green	64
				2041	Fern Green	47
				2042	Turquoise	35
				2043	Primary Green	31
				2044	Industrial Green	64
				2050	Yellow	80
				2051	Amber	71
				2052	Amber Blush	38
				2053	Bastard Amber	71
				2054	Goldenrod	63
				2055	Bright Straw	56
				2060	Medium Orange	51
				2061	Orange	44
				2070	Flame Red	27
				2071	Primary Red	25

Special Glass Color Filters

LSI will fabricate, on special order, dichroic glass color filters in most sizes and shapes not exceeding a 13" diameter circle overall.

FS4 — Color Filter Samples

To facilitate selection of glass color filters, LSI supplies a complete set of 1 3/4" X 1 3/4" labeled glass and dichroic samples in a handy carrying case.