

LP230 FIXTURE INSTALLATION AND OPERATION INSTRUCTIONS

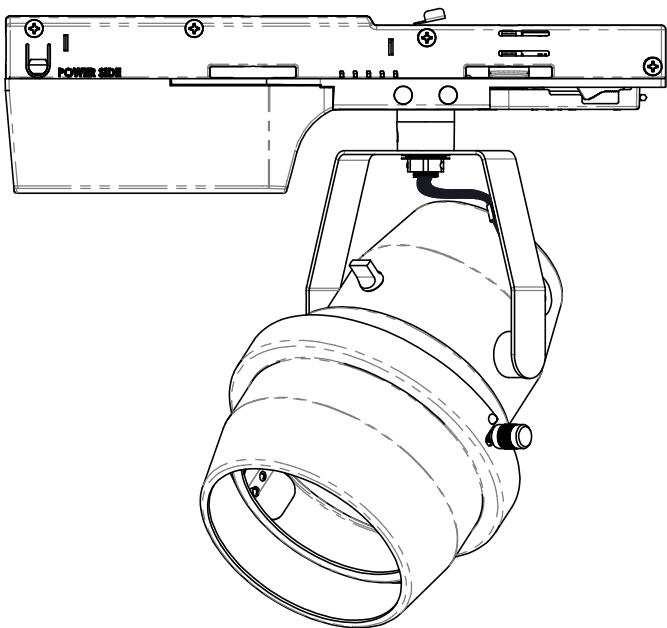

PRODUCT OVERVIEW

THE LP230 SERIES IS A TIGHTLY FOCUSED LED FIXTURE, SPECIFICALLY DESIGNED FOR MEDIUM THROW APPLICATIONS. THIS EFFICIENT, 13 WATT LED FIXTURE CREATES A 4 DEGREE BEAM WITH 70,000 CBCP WITH 810 LUMENS.

TABLE OF CONTENTS

PAGE 2: INSTALLING THE FIXTURE WITH THE -CT OR -PT FITTING ON AN LSI CONTROLTrack OR POWERTrack

PAGE 3: INSTALLING THE FIXTURE WITH A 5B CANOPY

PAGE 4: ACCESSORIES

PAGE 5: CROSS BAFFLE

PAGE 6: REPLACING THE LED MODULE



TO PREVENT RISK OF SHOCK, TURN OFF ELECTRICITY PRIOR TO INSTALLATION OR MAINTENANCE



TO PREVENT RISK OF FIRE, KEEP AWAY FROM COMBUSTIBLE MATERIALS

IMPORTANT SAFETY INSTRUCTIONS

THIS PRODUCT MUST BE INSTALLED IN ACCORDANCE WITH NATIONAL ELECTRICAL CODES AND ALL OTHER LOCAL CODES BY A PERSON FAMILIAR WITH THE CONSTRUCTION AND OPERATION OF THE PRODUCT AND THE HAZARDS INVOLVED.

- SEE THE FIXTURE LABEL FOR VOLTAGE AND WATTAGE INPUT.
- PLEASE CONSULT OUR PRODUCT CATALOG OR WEBSITE FOR AVAILABLE ACCESSORIES.
- WE RECOMMEND ANY ACCESSORIES ARE INSTALLED BEFORE FIXTURE INSTALLATION.
- PRIOR TO PERFORMING MAINTENANCE, TURN OFF AND DISCONNECT THE POWER TO THE FIXTURE AND ALLOW THE FIXTURE TO COOL OFF.
- DO NOT LOOK DIRECTLY AT THE LIT LED.

SAVE THESE INSTRUCTIONS

CONFIDENTIAL-PROPRIETARY INFORMATION - THE INFORMATION HEREIN IS PROTECTED UNDER COPYRIGHT AND IS OF A PROPRIETARY NATURE AND IS SUBMITTED IN CONFIDENCE FOR USE BY OUR CLIENTS ONLY. UNAUTHORIZED REPRODUCTION, PUBLICATION, DISTRIBUTION OR DISSEMINATION IN WHOLE OR PART, IS EXPRESSLY PROHIBITED. THE INFORMATION CONTAINED HEREIN IS AND REMAINS THE PROPERTY OF LIGHTING SERVICES INC. AND RECEIPT OR POSSESSION OF THIS INFORMATION CONFERS NO RIGHT IN OR LICENSE TO DISCLOSE TO OTHERS THE SUBJECT MATTER CONTAINED HEREIN FOR ANY BUT AUTHORIZED PURPOSES. COPYRIGHT LIGHTING SERVICES INC. ALL RIGHTS RESERVED



LP230 FIXTURE INSTALLATION AND OPERATION INSTRUCTIONS

INSTALLING THE FIXTURE WITH THE -CT OR -PT FITTING ON AN LSI CONTROLTrack OR POWERTrack

FOR USE WITH LSI CONTROLTrack OR POWERTrack SYSTEMS ONLY.

INSTALLATION INSTRUCTIONS: THE TRACK MUST ALREADY BE INSTALLED ACCORDING TO CODE REQUIREMENTS. WHEN INSTALLING OR USING THIS TRACK SYSTEM, BASIC SAFETY PRECAUTIONS SHOULD ALWAYS BE FOLLOWED, INCLUDING THE FOLLOWING:

- READ ALL INSTRUCTIONS.
 - DO NOT INSTALL ANY PART OF A TRACK SYSTEM LESS THAN 5 FEET ABOVE THE FLOOR (8 FEET FOR 277 VOLT).
 - DO NOT INSTALL ANY FIXTURE CLOSER THAN 6 INCHES FROM ANY CURTAIN OR SIMILARLY COMBUSTIBLE MATERIAL.
1. FLIP THE FITTING SWITCH OFF, OPEN THE POWER HANDLE (**FIG. 1**) AND OPEN THE DATA HANDLE (**FIG. 3**).
 2. ARE YOU USING A CONTROLTrack OR POWERTrack SYSTEM?
 - IF CONTROLTrack, MAKE SURE THE BRASS CONTACTS THAT CONNECT THE POWER ARE ON THE CORRECT SIDE. THE TRACK WILL HAVE ONE SIDE FOR POWER AND ONE SIDE FOR DATA. THE FITTING MUST BE INSERTED FACING THE PROPER DIRECTION.
 - IF POWERTrack, THIS MAY A ONE-CIRCUIT OR TWO-CIRCUIT SYSTEM. IF ONE-CIRCUIT, MAKE SURE THE BRASS CONTACTS THAT CONNECT THE POWER ARE ON THE CORRECT SIDE. IF TWO-CIRCUIT, INSERTING THE FITTING IN ONE DIRECTION CONNECTS TO CIRCUIT ONE. REMOVING AND REVERSING THE DIRECTION OF THE FITTING CONNECTS TO CIRCUIT TWO.
 3. INSERT THE FITTING STRAIGHT UP INTO THE TRACK UNTIL FULLY SEATED (**FIG. 3**).
 4. CLOSE THE POWER AND DATA HANDLES AND FLIP THE FITTING SWITCH ON (**FIG. 2, 4**).
WARNING: DO NOT LOOK DIRECTLY AT LIT LED.
 5. TO REMOVE THE FITTING, HOLD THE FIXTURE IN PLACE, FLIP THE FITTING SWITCH TO OFF, OPEN THE POWER AND DATA HANDLES, AND PULL THE FITTING STRAIGHT OFF THE TRACK.

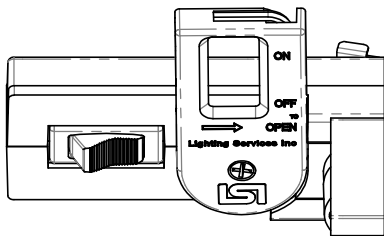

FIGURE 1. FITTING WITH SWITCH OFF AND POWER HANDLE OPEN

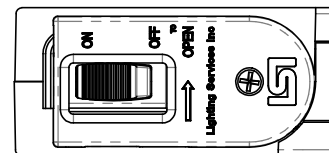

FIGURE 2. FITTING WITH SWITCH ON, AND POWER HANDLE CLOSED

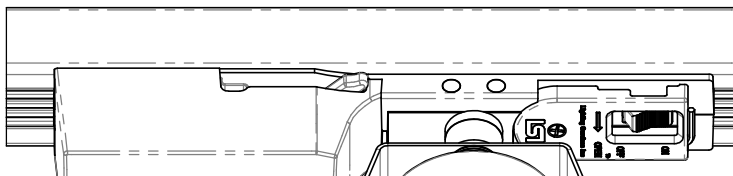

FIGURE 3. FITTING INSERTED IN TRACK, DATA HANDLE OPEN

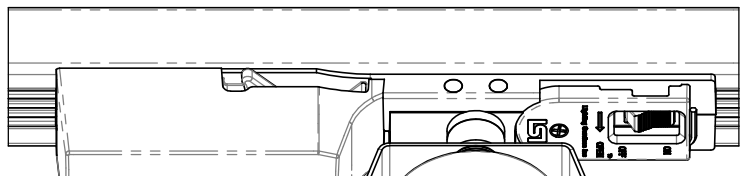

FIGURE 4. FITTING INSERTED IN TRACK, DATA HANDLE CLOSED



LP230 FIXTURE INSTALLATION AND OPERATION INSTRUCTIONS

INSTALLING THE FIXTURE WITH A 5B CANOPY

BEFORE INSTALLING: CONSULT THE CODE REQUIREMENTS FOR FIXTURE MOUNTING. MOUNT THE FIXTURE TO A CEILING CONSTRUCTED OF NON-COMBUSTIBLE MATERIAL, AWAY FROM ANY FLAMMABLE MATERIALS.

INSTALLATION INSTRUCTIONS:

1. TURN OFF ALL POWER TO THE FIXTURE MOUNT.
2. REMOVE THE TWO SUPPLIED CANOPY MOUNTING SCREWS, AND CROSSBAR, FROM THE HARDWARE BAG SUPPLIED WITH THE FIXTURE.
3. ATTACH THE CANOPY CROSSBAR (**FIG. 5**) TO A CEILING JUNCTION BOX WITH TWO SCREWS (SUPPLIED BY OTHERS).
4. FASTEN THE POWER WIRES (**FIG. 5**) FROM THE JUNCTION BOX TO THE FIXTURE WIRES. YOU MAY USE THE SUPPLIED CROSSBAR HOOK TO HOLD THE FIXTURE IN PLACE WHILE COMPLETING WIRING CONNECTIONS (**FIG. 6**).

NOTE: CONNECT GREEN TO GROUND, BLACK TO THE CIRCUIT LINE, AND WHITE TO NEUTRAL.

5. ATTACH THE CANOPY TO THE CEILING WITH THE TWO SUPPLIED CANOPY MOUNTING SCREWS (**FIG. 7**).

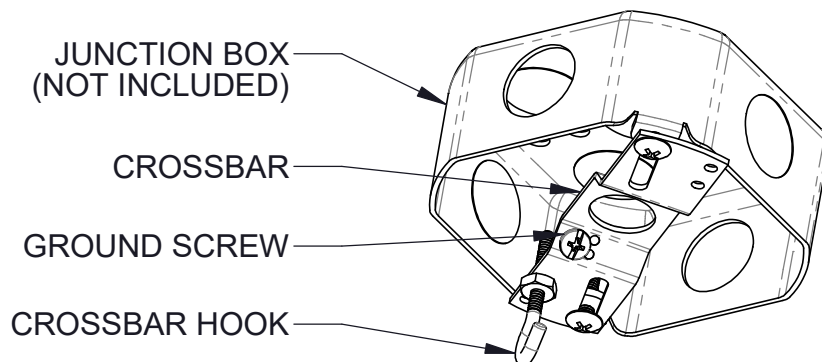

FIGURE 5. JUNCTION BOX, CROSSBAR, GROUND SCREW, AND CROSSBAR HOOK (GREEN)

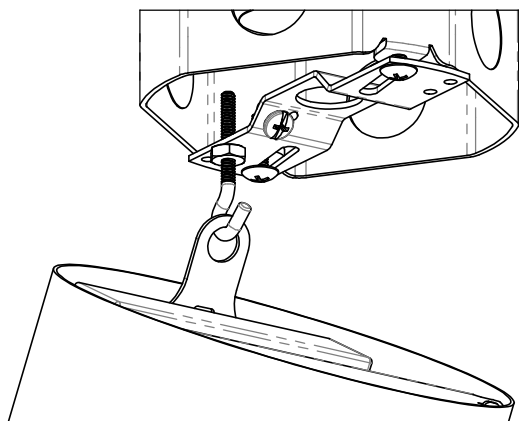

FIGURE 6. 5B CANOPY MOUNTED TO CROSSBAR HOOK

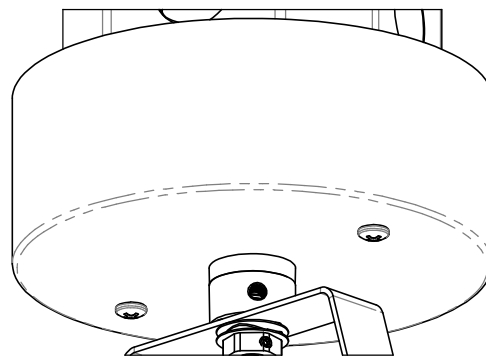

FIGURE 7. INSTALLED 5B CANOPY



LP230 FIXTURE INSTALLATION AND OPERATION INSTRUCTIONS

ACCESSORIES

1. TURN FIXTURE SWITCH OFF AND LET FIXTURE COOL.
WARNING: LED MODULE AND FIXTURE MAY BE HOT.
2. OPEN THE FIXTURE VIA THE RELAMPING KNOB (FIG. 8).
3. YOU CAN INSERT ANY "A" SIZE ACCESSORY INTO THE FRONT, VIA INTERNAL SPRING CLIPS (FIG. 9, 10). THE LP230 ACCESSORY HOLDER CAN HOLD UP TO THREE ACCESSORIES.
4. CLOSE FRONT AND TURN RELAMPING KNOB CLOCKWISE UNTIL SNUG.
5. TURN FIXTURE SWITCH ON.
WARNING: DO NOT LOOK DIRECTLY AT LIT LED.

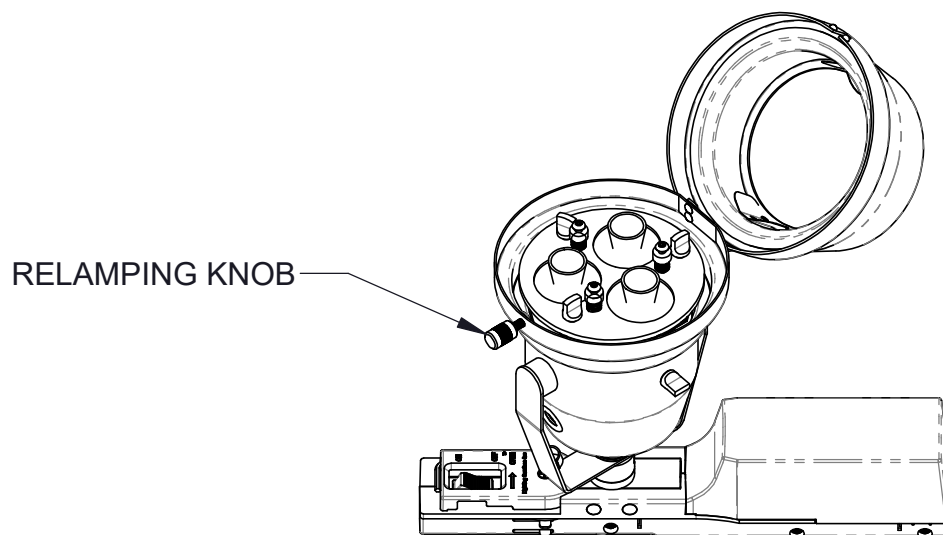

FIGURE 8. FIXTURE OPENED

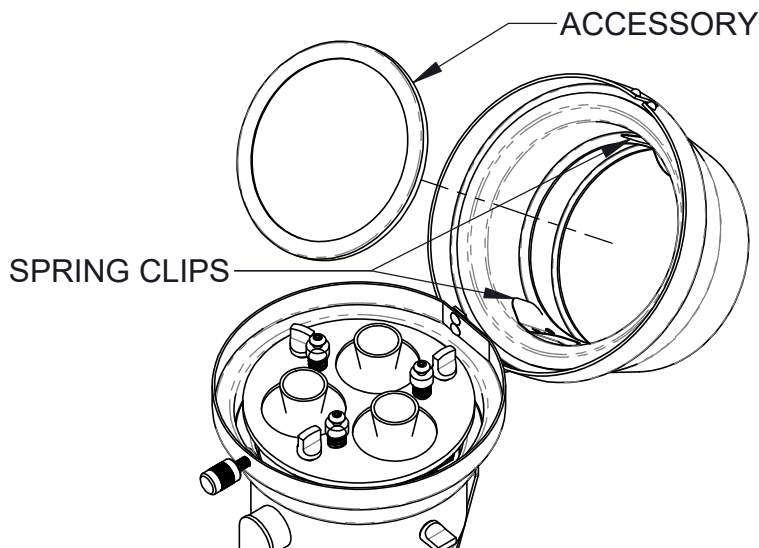

FIGURE 9. ACCESSORY BEING PLACED INTO ACCESSORY HOLDER

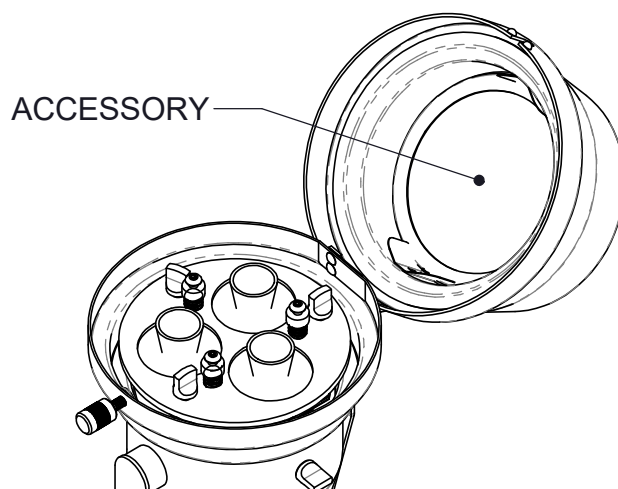

FIGURE 10. ACCESSORY INSTALLED IN ACCESSORY HOLDER



LP230 FIXTURE INSTALLATION AND OPERATION INSTRUCTIONS

CROSS BAFFLE (FOR GLARE CONTROL WHEN USING GEL ACCESSORIES)

1. TURN FIXTURE SWITCH OFF AND LET FIXTURE COOL.
WARNING: LED MODULE AND FIXTURE MAY BE HOT.
2. OPEN THE FIXTURE VIA THE RELAMPING KNOB (FIG. 11).
3. REMOVE ALL ACCESSORIES AND ACCESSORY HOLDER (FIG. 12).
4. PLACE CROSS BAFFLE STRAIGHT INTO FIXTURE FRONT (FIG. 13).
5. REINSERT THE ACCESSORY HOLDER AND ACCESSORIES AND CLOSE THE FRONT OF THE FIXTURE. (FIG. 13, 14).
6. TURN THE RELAMPING KNOB CLOCKWISE UNTIL SNUG.
7. TURN FIXTURE SWITCH ON.
WARNING: DO NOT LOOK DIRECTLY AT LIT LED.

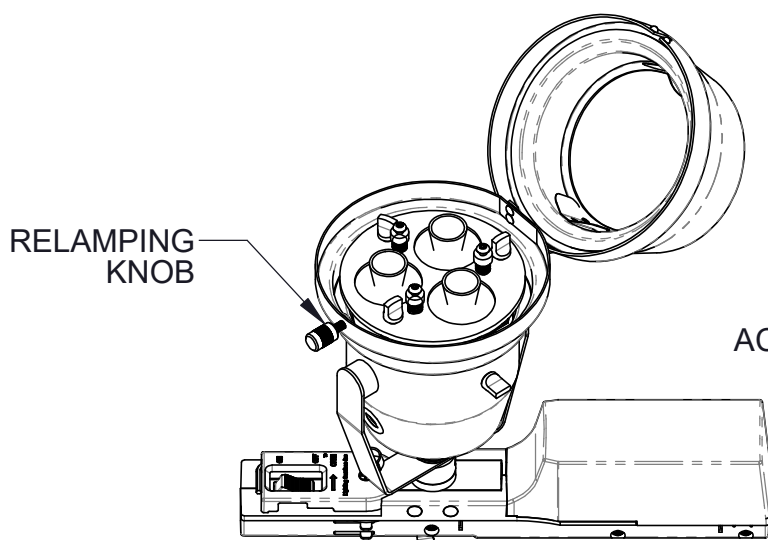

FIGURE 11. FIXTURE FRONT OPEN

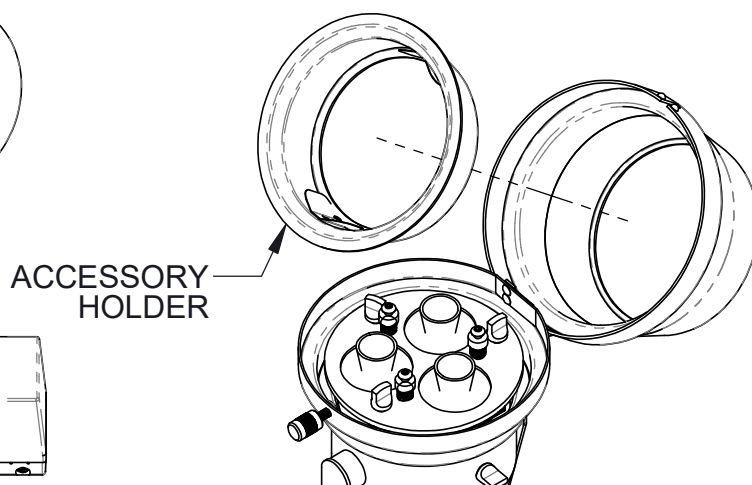

FIGURE 12. ACCESSORY HOLDER REMOVED FROM FIXTURE FRONT

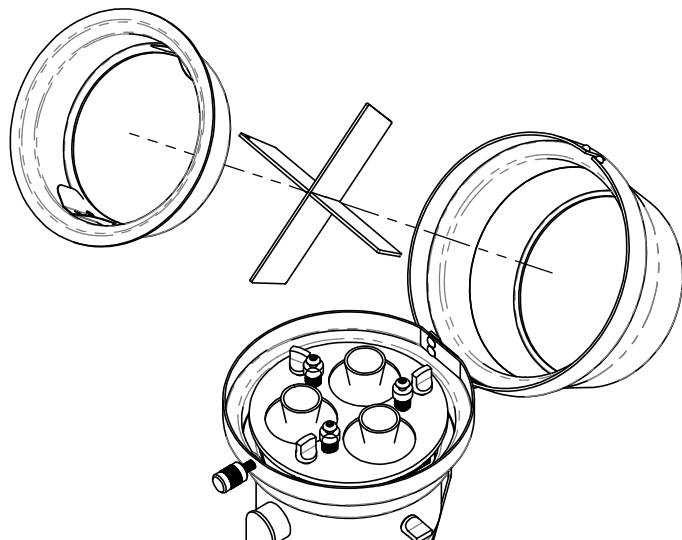

FIGURE 13. CROSS BAFFLE INSTALLATION SEQUENCE

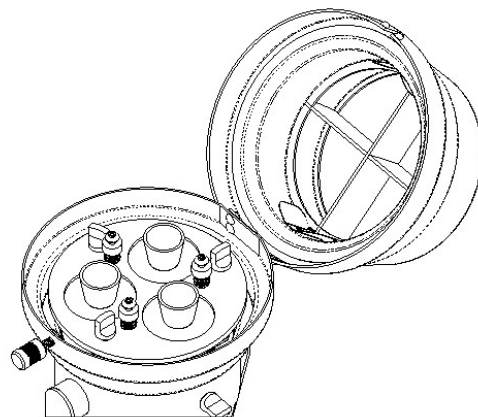

FIGURE 14. CROSS BAFFLE INSTALLED



LP230 FIXTURE INSTALLATION AND OPERATION INSTRUCTIONS

REPLACING THE LED MODULE

IF YOU NEED TO CHANGE THE LED MODULE, FOLLOW THE STEPS BELOW.

1. REMOVE ALL POWER TO THE FIXTURE, INCLUDING THE FIXTURE SWITCH ON THE FITTING, AND LET THE LED MODULE COOL.
WARNING: LED MODULE AND FIXTURE MAY BE HOT.
2. OPEN THE FIXTURE VIA THE RELAMPING KNOB (**FIG. 15**).
3. REMOVE THE LED MODULE BY UNSCREWING THE THREE SCREWS SECURING IT TO THE HEAT SINK (**FIG. 15**). SCREWS ARE CAPTIVE AND WILL REMAIN WITH THE LED MODULE.
4. REMOVE THE LED POWER HARNESS FROM THE RECEPTACLE ON THE LED BOARD (**FIG. 16**).
5. REMOVE THE OLD LED MODULE FROM THE FIXTURE.
6. RECONNECT THE LED POWER HARNESS TO THE RECEPTACLE ON THE NEW LED BOARD (**FIG. 16**).
7. INSTALL THE NEW LED MODULE BY FIRMLY SCREWING THE THREE SCREWS TO THE HEAT SINK (**FIG. 15**).
8. RESTORE ALL POWER TO THE FIXTURE.
WARNING: DO NOT LOOK DIRECTLY AT LIT LED.

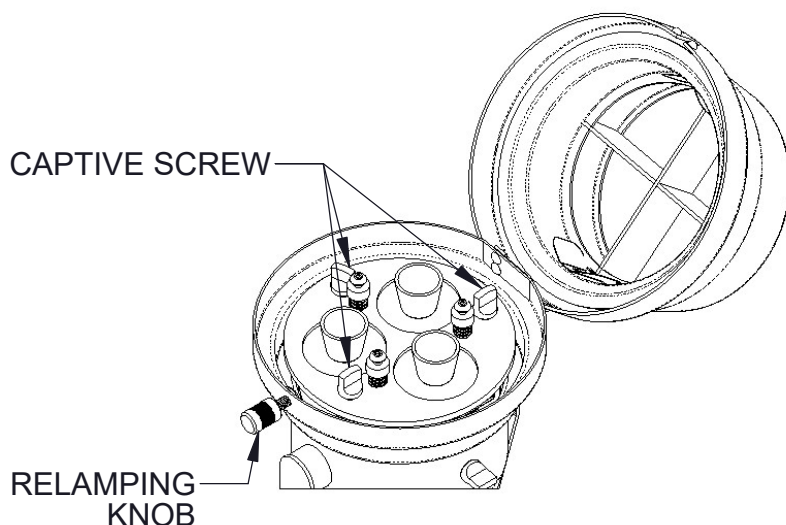

FIGURE 15. FIXTURE FRONT OPEN, SHOWING CAPTIVE SCREWS

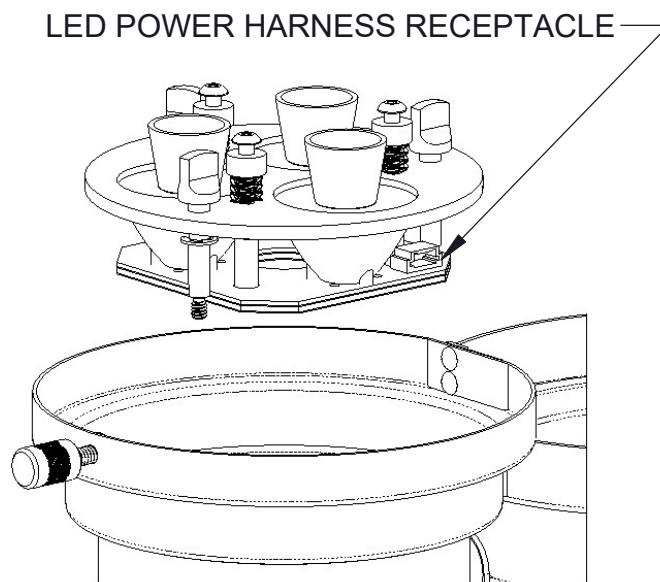

FIGURE 16. LED POWER HARNESS RECEPTACLE

