

## LumeLEX 2044 SERIES INSTALLATION INSTRUCTIONS

### Important

**THIS SHEET CONTAINS IMPORTANT SAFETY INSTRUCTIONS.  
SAVE THESE INSTRUCTIONS.**

---

### Warning

**This product must be installed in accordance with National Electrical Codes and all other local codes by a person familiar with the construction and operation of the product and the hazards involved.**

**To prevent electrical shock, turn off the power during installation or maintenance.**

**To reduce the risk of fire, keep away from combustible materials.**

---

### Product Overview

The LumeLEX 2044 Series is a clean, elegant stem mounted fixture with a discreetly hidden driver, making it appear no different than a traditional halogen source.

With independent ratings of 98 CRI, the LumeLEX 2044 Series, based on the latest in Remote Corrected Cold Phosphor Technology by Xicato, has the highest Color Rendering Index of any LED on the market today, producing the most consistent, highest quality white light and maintaining extremely tight color control (within 2 MacAdam ellipses, vs. the NEMA standard of 7).

See the fixture label for voltage and wattage input.

Please consult our *Product Catalog* or web site for available accessories.

**We recommend that you first install the reflector and any accessories before installing the fixture.**

*LumeLEX 2044 Series Spotlight*



### Purpose of This Sheet

The purpose of this sheet is to provide step-by-step instructions to help you:

- Install accessory reflectors and accessory cartridge
- Install the fixture with any of the following: -00 fitting on an LSI track, -BUS fitting on an LSI Busway, 5A canopy, -2G universal flange fitting, or -3G C-Clamp fitting
- Aim the self-locking and wrench-locking fixture
- Service the 50,000 hour LED driver

### Dimming

- The LX2044 is fully dimmable using compatible trailing-edge, low-voltage electronic dimmers.
  - Please review dimming application guide for detailed information and a list of compatible dimmers
-

### Accessory Cartridge Overview

The LumeLEX 2044 series fixture contains an adjustable 2-piece accessory cartridge capable of holding Size-AA gels, and up to 2 Size-AA rimmed accessories.

### Installing Size AA Accessories

STEP	ACTION
1	Remove accessory cartridge by pulling on lip of cartridge ( <b>Fig. 1</b> ).
2	Insert the gels first ( <b>see pg. 3</b> ) and then 1 or 2 Size-AA rimmed accessories can be inserted ( <b>Fig. 2</b> ).
3	Set inner cartridge to the home position before inserting back into the fixture ( <b>Fig. 3</b> ).
4	For orientation specific accessories such as a spread lens or Gel: Prior to fully reinserting the cartridge, turn fixture on and hold cartridge in front of fixture; rotate to orient beam as desired ( <b>Fig. 4</b> ).
5	Firmly push cartridge in until lip is fully seated on housing. <i>Note:</i> Reflector will push against any rimmed accessories automatically adjusting the inner cartridge to proper focal position.



Figure 1.



Figure 2. Push accessory in so it lays flat and snaps into the retainer clip.



Figure 3. Press the inner cartridge in until the stops prevent it from moving further.

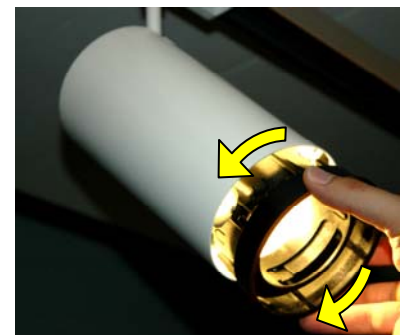

Figure 4. If required rotate the Accessory Cartridge to aim an orientation specific accessory.

### Changing Accessories

STEP	ACTION
1	Remove accessory cartridge by pulling on lip of cartridge ( <b>Fig. 1</b> ).
2	Change out accessories as desired. Accessories will pop out of retainer clip. Insert the gels, or up to 2 Size-AA rimmed accessories ( <b>Fig. 2</b> ).
	Follow steps 3 through 5 above

**Backer Ring Overview**

The LumeLEX 2044 series fixture is capable of holding Size-AA gels. Typical Backer Ring and Gel insert are shown in figure 5

See pg. 2 for removing and installing accessory cartridge.



Figure 5. Typical Backer Ring and Gel.

**Installing Size AA Gel**

STEP	ACTION
1	Remove accessory cartridge ( <b>Fig. 1</b> )
2	Insert the desired Gel(s).
3	Insert Backer ring or rimmed accessory and push down on rim edge evenly with finger tips until it is seated flat on the bottom of the cartridge ( <b>Fig. 6</b> ).
Up to 2 Size-AA accessories may be installed on top of Gels, if desired.	



Figure 6. Insert Size-AA Gel into Cartridge and push down on the edge of the size-AA rimmed accessory or Backer Ring to support Gel or Hood.

**Installing Size-AA Hood**

STEP	ACTION
1	Remove accessory cartridge ( <b>Fig. 1</b> )
2	Insert the Hood. ( <b>Fig. 7</b> )
3	Insert Backer Ring or rimmed accessory and push down on rim edge evenly with finger tips until it is seated flat on the bottom of the cartridge ( <b>Fig. 6</b> ).
Several Gels and up to 1 Size-AA accessory may be installed on top of hood, if desired.	
Fully assembled Hood is shown in Fig. 8	

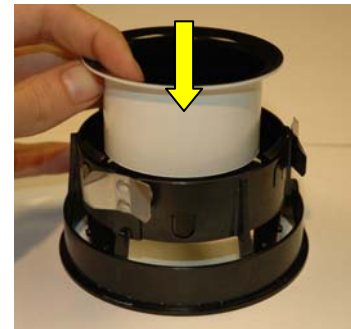

Figure 7. Place hood in cartridge and push down on edge



Figure 8. Cartridge assembled with hood

**Reflector Overview** The LumeLEX 2044 series fixture is designed for use with interchangeable 20°/40°/60° LX-Mxx-REF (70mm) size reflectors.

**Before Installing the Fixture:** The reflector is attached using a 3-tab bayonet system. To install the reflector, insert the tabs into the notches on the LED Adapter Ring and rotate clockwise.

### Changing the Reflector

STEP	ACTION
1	Remove accessory cartridge. (Fig. 1)
2	Insert the new reflector by lining up the three tabs with the notches in the LED Adapter Ring, and rotating clockwise until it is secured in place. (Fig. 9)
3	Remove the reflector by turning it counter-clockwise, then pulling it out of the fixture (Fig. 10).
4	Install accessory cartridge. (Fig. 4)

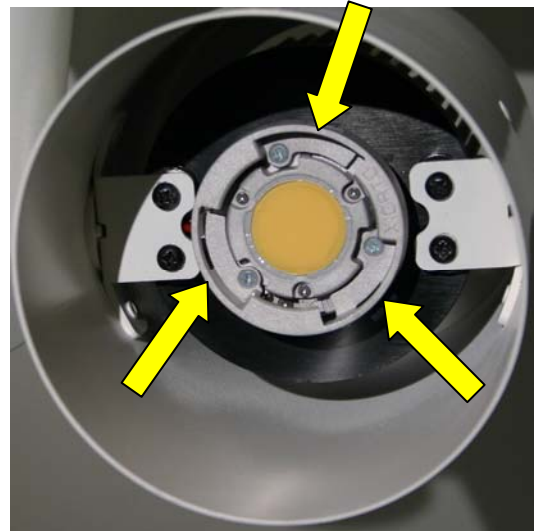

**Figure 9.** The three notches in the LED Adapter Ring. Align the reflector tabs with these notches and rotate clockwise to secure it in place.

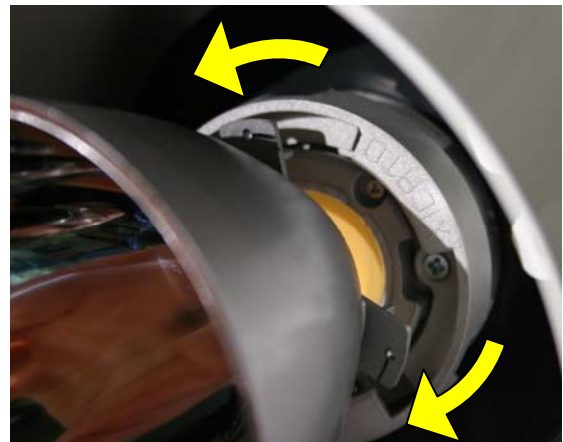

**Figure 10.** Rotate reflector counter-clockwise to remove it.

*Installing the Fixture with the -00 Fitting on an LSI Track or a -BUS fitting on an LSI Busway*

**FOR USE WITH LSI 3, 4, 5, 6, 8, AND 9 SERIES TRACK AND LSI 20 SERIES BUSWAY SYSTEMS ONLY.**

**INSTALLATION INSTRUCTIONS:** The track or busway must already be installed according to code requirements. When installing or using this track or busway system, basic safety precautions should always be followed, including the following:

- Read all instructions.
- Do not install any part of a track or busway system less than 5 feet above the floor (8 feet for 277 volt).
- Do not install any fixture closer than 6 inches from any curtain or similar combustible material.

STEP	ACTION
1	Flip the fitting switch off and open the fitting handle (Fig. 11).
2	Are you using a one-circuit or two-circuit system? <ul style="list-style-type: none"> <li>▪ <i>If one-circuit</i>, make sure the brass contacts that protrude from the side of the fitting face the copper busbars inside the track or busway.</li> <li>▪ <i>If two-circuit</i>, inserting the fitting in one direction connects to circuit one. Removing and reversing the direction of the fitting connects to circuit two.</li> </ul>
3	Insert the fitting straight up into the track or busway until fully seated (Fig. 12).
4	Close the handle and flip the fitting switch on (Fig. 13). <b>WARNING: Do not look directly at lit LED.</b>
5	To remove the fitting, hold the fixture in place, flip the fitting switch off, open the handle, and pull the fitting straight off the track or busway.



**Figure 11. Fitting with switch OFF and handle OPEN.**



**Figure 12. Inserted fitting**



**Figure 13. Switch ON, fitting handle closed**

*Installing the Fixture with a 5A Canopy*

**Before Installing:** Consult the code requirements for fixture mounting. Mount the fixture to a ceiling constructed of non-combustible material, away from any flammable materials.

STEP	ACTION
1	Turn off all power to the fixture mount.
2	Unscrew the 2 supplied canopy mounting screws, and remove the crossbar from the canopy (Fig. 14).
3	Attach the canopy crossbar (Fig. 15) to a ceiling junction box with 2 screws (supplied by others).
4	Fasten the power wires (Fig. 15) from the junction box to the fixture wires. <i>Note:</i> Connect green to ground, black to the circuit line, and white to neutral.
5	Attach the canopy to the ceiling with the 2 supplied canopy mounting screws.



**Figure 14. Fixture mounted on the 5A Canopy**

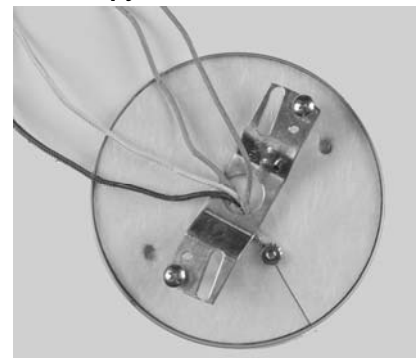

**Figure 15. Ground and power wires with canopy crossbar**

### Installing the Fixture with a -2G Universal Flange Fitting or a -3G C-Clamp Fitting

**Before Installing:** Consult the code requirements for fixture mounting, and check the distance-from-wall label inside the fixture. Mount away from any flammable materials.

**For the -2G fitting, follow steps 1, 2, 4, and 5.  
For the -3G fitting, follow steps 1, 3, 4, and 5.**

STEP	ACTION
1	Turn off all power to the fixture.
2	Attach the -2G fitting ( <b>Fig. 16</b> ) to any non-combustible material, using the 2-hole flanged mounting plate with 2 screws (supplied by others) or bolt-up applications, such as Unistrut or Kindorf systems.
3	Attach the -3G fitting ( <b>Fig. 17</b> ) to a non-combustible pipe measuring 5/8" to 2" in outside diameter, and then secure the fitting by turning the C-clamp bolt clockwise.
4	Plug the fixture into a power source. <b>IMPORTANT SAFETY INSTRUCTIONS</b> Never use with an extension cord unless the plug can be fully inserted. Do not alter the plug.
5	Turn on the main power, and then flip the fitting switch on. Note: The switch is located on the base of fitting.



**Figure 16. -2G universal flange fitting**

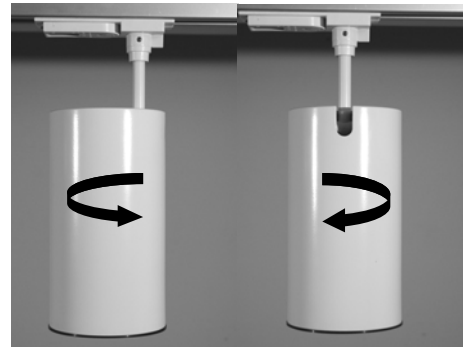

**Figure 17. -3G C-clamp fitting**

**Aiming the Self-Locking and Wrench-Locking Fixtures**

**NOTE:** Allen key storage is only on Track and Busway Fittings.

STEP	ACTION
1	Turn off all power to the fixture, including the fixture switch on the fitting, and let the LED cool. <b>WARNING: LED and fixture may be hot.</b>
2	Do you want to aim the fixture horizontally or vertically? <ul style="list-style-type: none"> <li>▪ For horizontal aiming, hold the Fixture and turn it left or right until you achieve your desired orientation (Fig. 18).</li> <li>▪ For vertical aiming, hold the Fixture and angle it up and down until you achieve your desired orientation (Fig. 19).</li> <li>▪ For wrench locking: After aiming, insert the Allen key into the horizontal or vertical focus lock (Fig. 20), and turn it clockwise to tighten.</li> </ul> <p>Note: For track and busway fixtures, the Allen key is stored in the fitting handle (Fig. 21).</p>
3	Restore power. <b>WARNING: Do not look directly at the lit LED.</b>



**Figure 18.** Turn Fixture left or right to set the horizontal focus.



**Figure 19.** Angle Fixture up or down to set the vertical focus.

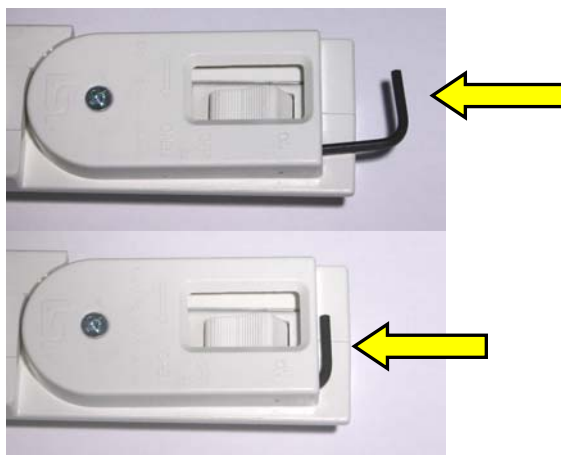

**Figure 21.** Allen key storage in fitting. Push in to secure the key.



**Figure 20.** Horizontal focus lock (top arrow). Vertical focus lock (bottom arrow).

### Replacing the LED Module

If you need to change the LED Module, follow the steps below.

STEP	ACTION
1	Remove all power to the fixture, including the fixture switch on the fitting, and let the LED Module cool. <b>WARNING: LED Module and fixture may be hot.</b>
2	Remove the reflector by turning it counter-clockwise, then pulling it off the fixture ( <b>Fig. 10</b> ) and setting it aside.
3	Remove the Adapter Ring by unscrewing the three screws securing it to the LED Module ( <b>Fig. 21</b> ). Pull the Adapter Ring off the fixture and set aside.
4	Remove the LED Module by unscrewing the three screws securing it to the Heat Sink ( <b>Fig. 22</b> ).
5	Pull out the wires and open the Quick Connect tabs to disconnect the LED wires from the circuit ( <b>Fig. 23</b> ).
6	Remove the old LED Module from the fixture.
7	Reconnect the new LED wires to the Quick Connect by lifting the tab and inserting the wire ( <b>Fig. 23</b> ). <i>Note: Ensure that the wires are paired by color as black to black and red to purple.</i> <i>Note: The driver has two black wires:</i> - Input black (line voltage), which is paired with white wire - Output black (low voltage/LED power), which is paired with purple or colored wire
8	Install the new LED Module by firmly screwing the three screws to the Heat Sink ( <b>Fig. 22</b> ).
9	Reattach the Adapter Ring by screwing the three screws to secure it to the LED Module ( <b>Fig. 21</b> ).
10	Reattach the reflector by lining up the tabs with the notches in the LED Adapter Ring and rotating clockwise until it is secured in place ( <b>Fig. 9</b> ).
11	Restore all power to the fixture. <b>WARNING: Do not look directly at the lit LED.</b>

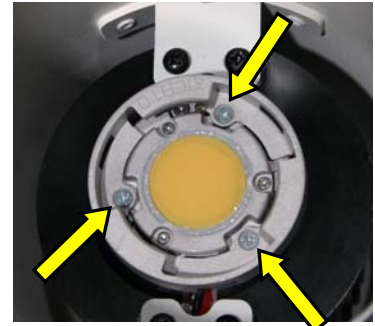

Figure 21. The three screw locations for the Adapter Ring.

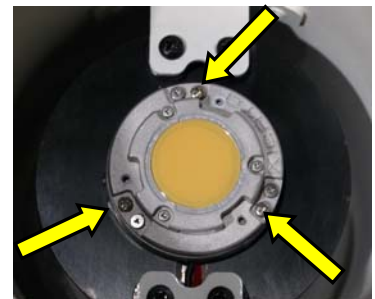

Figure 22. The three screw locations for the LED Module.

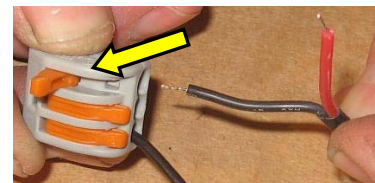

Figure 23. A Quick Connector with tab lifted. Please refer to the label on the driver for wire orientation.