

LumeLEX 2030/2031 SERIES INSTALLATION INSTRUCTIONS

Important **THIS SHEET CONTAINS IMPORTANT SAFETY INSTRUCTIONS. SAVE THESE INSTRUCTIONS.**

Warning **This product must be installed in accordance with National Electrical Codes and all other local codes by a person familiar with the construction and operation of the product and the hazards involved.**

To prevent electrical shock, turn off the power during installation or maintenance.

To reduce the risk of fire, keep away from combustible materials.

Product Overview

The LumeLEX 2030/2031 Series is a clean, elegant stem mounted LED spotlight with a discreetly hidden driver, making it appear no different than a traditional halogen source.

With independent ratings of 97CRI, the LumeLEX 2030/2031 series, based on the latest in Remote Corrected Cold Phosphor Technology by Xicato, has the highest Color Rendering Index of any LED on the market today, producing the most consistent, highest quality white light and maintaining extremely tight color control (within 2 MacAdam ellipses, vs. the NEMA standard of 7). The LumeLEX 2030/2031 series also features a snap-out cross baffle and accessory cartridge which accepts up to two optical accessories, size 'AAA'.

See the fixture label for voltage and wattage input.

Please consult our Product Catalog or web site for available accessories.

We recommend that you first install the reflector and any accessories before installing the fixture.

LumeLEX 2030 Series Spotlight



Purpose of This Sheet

The purpose of this sheet is to provide step-by-step instructions to help you:

- Install the fixture with any of the following: -00E fitting on an LSI track, -BUSE fitting on an LSI Busway, -5AE canopy.
 - Install accessory filters and reflectors
 - Aim the self-locking and wrench-locking fixture
 - Clean the optical surfaces and reflector
-

**Changing
or
Installing
the
Reflector**

Before Changing Reflector: To maintain the fixture's current orientation, change the reflector with the fixture in its location. If the orientation does change, refer to the "Aiming the Fixture" section of this sheet. Refer to our *Product Catalog* or web site for reflector options.

Follow steps 1, 2, 4, and 5 if you are installing the reflector for the first time.

STEP	ACTION
1	Turn off all power to the fixture, including the fixture switch on the fitting, and let the LED cool. WARNING: LED and fixture may be hot.
2	Remove the cylinder housing by grasping the fitting stem in one hand and the cylinder housing in the other. Pull in opposite directions while rocking the housing gently side to side. (Fig. 1).
3	Remove the reflector by turning it counter-clockwise, then pulling it out of the fixture. (Fig. 2).
4	Insert the new reflector by lining up the three tabs with the notches in the LED Adapter Ring, and rotating clockwise until it is secured in place. (Fig 3)
5	Close the fixture front by replacing the cylinder housing. Align the stem notch to the cylinder housing notch and push the cylinder housing onto the stem notch until it clicks into place and is secured. (Fig. 1).
6	Restore power. WARNING: Do not look directly at the lit LED.

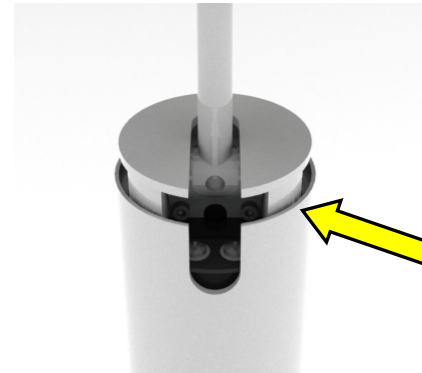

Figure 1. Cylinder housing loosened and notches aligned (arrow). Pull off to expose lamp, or push onto stem to close and secure housing.

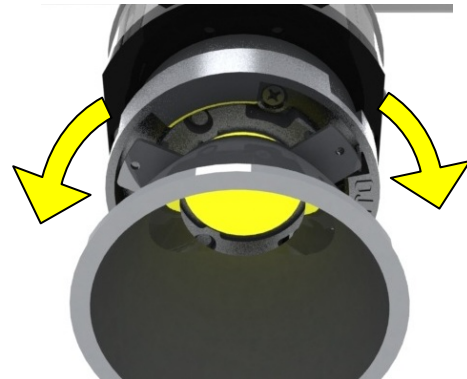

Figure 2. Rotate reflector counter-clockwise to remove it.

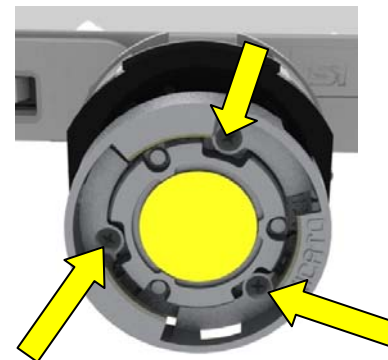

Figure 3. The three notches in the LED Adapter Ring. Align the reflector tabs with these notches and rotate clockwise to secure in it.

Installing the Fixture with the -00E Fitting on an LSI Track or a -BUSE fitting on an LSI Busway

FOR USE WITH LSI 3, 4, 5, 6, 8, AND 9 SERIES TRACK AND LSI 20 SERIES BUSWAY SYSTEMS ONLY.

INSTALLATION INSTRUCTIONS: The track or busway must already be installed according to code requirements. When installing or using this track or busway system, basic safety precautions should always be followed, including the following:

- Read all instructions.
- Do not install any part of a track or busway system less than 5 feet above the floor (8 feet for 277V).
- Do not install any fixture closer than 6 inches from any curtain or similar combustible material.

STEP	ACTION
1	Flip the fitting switch off and open the fitting handle (Fig. 4).
2	Are you using a one-circuit or two-circuit system? <ul style="list-style-type: none"> ▪ <i>If one-circuit</i>, make sure the brass contacts that protrude from the side of the fitting face the copper busbars inside the track or busway. ▪ <i>If two-circuit</i>, inserting the fitting in one direction connects to circuit one. Removing and reversing the direction of the fitting connects to circuit two.
3	Insert the fitting straight up into the track or busway until fully seated (Fig. 5).
4	Close the handle and flip the fitting switch on (Fig 6). WARNING: Do not look directly at lit LED.
5	To remove the fitting, hold the fixture in place, flip the fitting switch off, open the handle, and pull the fitting straight off the track or busway.



Figure 4. Fitting with switch OFF and handle OPEN.



Figure 5. Inserted fitting



Figure 6. Switch ON, fitting handle closed

Installing the Fixture with a 5AE Canopy

Before Installing: Consult the code requirements for fixture mounting. Mount the fixture to a ceiling constructed of non-combustible material, away from any flammable materials.

STEP	ACTION
1	Turn off all power to the fixture mount.
2	Unscrew the 2 supplied canopy mounting screws, and remove the crossbar from the canopy (Fig. 7).
3	Attach the canopy crossbar (Fig. 8) to a ceiling junction box with 2 screws (supplied by others).
4	Fasten the power wires (Fig. 8) from the junction box to the LED driver. Secure the driver inside the junction box with tape supplied, taking care not to pinch or damage any wires. (Fig. 8) Note: Connect green to ground, black to the circuit line, and white to neutral.
5	Attach the canopy to the ceiling with the 2 supplied canopy mounting screws.



Figure 7. Fixture mounted on the 5AE Canopy

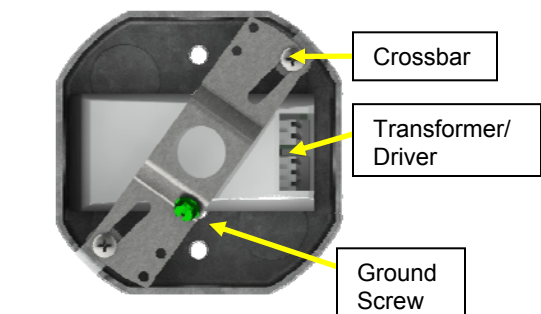

Figure 8. Junction Box, crossbar, ground screw (green) and a transformer/driver secured.

Installing Accessory Filters and Reflectors

Before Installing: The LumeLEX 2030/2031 has a removable accessory cartridge that holds size-AAA LSI filters and accessories, as well as other reflectors. The LumeLEX 2030/2031 package includes accessory cartridges and a reflector. Consult our *Product Catalog* or web site for accessory recommendations.

STEP	ACTION
1	Turn off all power to the fixture, including the fixture switch on the fitting, and let the lamp cool. WARNING: LED and fixture may be hot.
2	Remove the cross-baffle cartridge assembly by pulling it out of the cylinder housing (Fig. 9).
3	Insert any double combination of size-AAA filters and accessories into the Accessory Cartridge Clips (Fig. 10)(LX-2030) or (Fig 11)(LX-2031). Alternatively, the Accessory Cartridge will accept a single or combination of size-AAA gels, which are secured with the included Backer Ring (Fig. 10). Insert the gel into the Accessory Cartridge, taking care to orient non-symmetrical gels properly (refer to instruction sheet for LX2031 for specific gel orientation) and having the dull side facing in towards the LED. Secure the gels by inserting the backer ring on top and seating it firmly in the cartridge. 4 Reinsert Accessory Cartridge into the cylinder housing by pushing in the Retention Tabs on the sides of the cartridge (Fig. 10). Ensure that the cartridge is pushed all the way in, with the Cross-Baffle being flush or below the front edge of the housing (Fig.9). For LX-2031, ensure that the top of the Kicker Reflector Bracket is aligned with the slot in the LX-2031 front. Push until the top of the Kicker Reflector Bracket is bottomed out in the slot. (Fig 11) 5 Restore power. WARNING: Do not look directly at the lit LED.



Figure 9. Remove Cross-Baffle cartridge assembly by pulling it out of the cylinder housing. Cross-Baffle should be flush or below front edge of housing when installed.

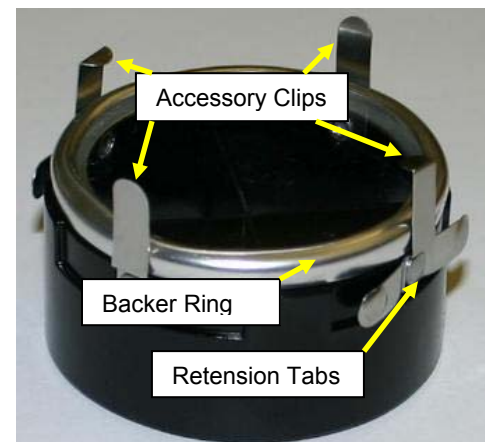

Figure 10(LX-2030). Accessory Clips, Retention Tabs, Backer Ring.

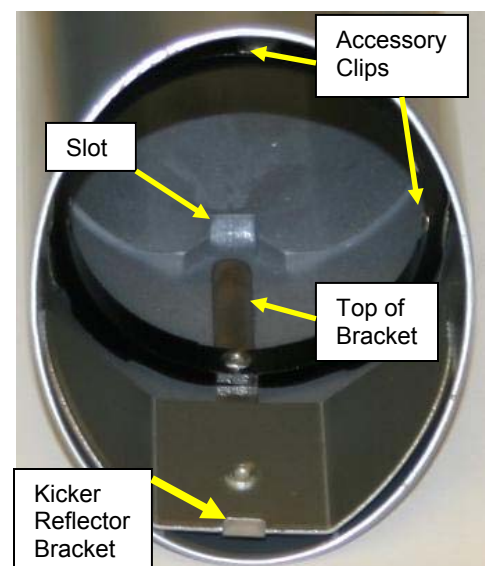

Figure 11(LX-2031). Accessory Clips, Tabs, Kicker Reflector Bracket

Aiming the Self-Locking and Wrench-Locking Fixtures

Before Aiming: For self-locking, you do not need an external locking device to set the horizontal and vertical focus. For wrench locking, use the supplied Allen key (3/32 inches) to set and lock the horizontal and vertical focus.

STEP	ACTION
1	Turn off all power to the fixture, including the fixture switch on the fitting, and let the lamp cool. WARNING: LED and fixture may be hot.
2	Do you want to aim the fixture horizontally or vertically? <ul style="list-style-type: none"> ▪ For horizontal aiming, hold the lamp housing and turn it left or right until you achieve your desired orientation (Fig. 12). ▪ For vertical aiming, hold the lamp housing and angle it up and down until you achieve your desired orientation (Fig. 13). ▪ For wrench locking: After aiming, insert the Allen key into the horizontal or vertical focus lock (Fig. 14), and turn it clockwise to tighten. <p><i>Note:</i> Allen key is supplied for track and busway fixtures. It is stored in fitting handle (Fig. 15).</p>
3	Restore power. WARNING: Do not look directly at the lit LED.



Figure 12. Turn fixture left or right to set the horizontal focus.

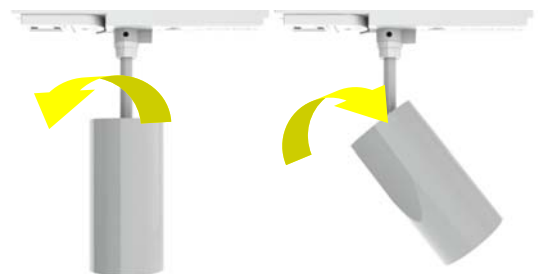

Figure 13. Angle fixture up or down to set the vertical focus.

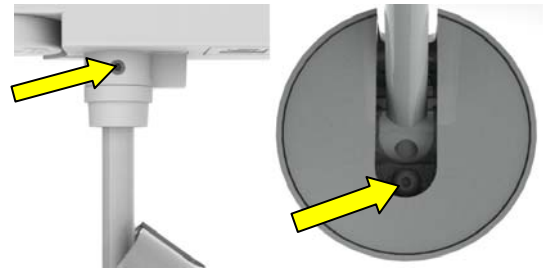

Figure 14. Horizontal focus lock (L). Vertical focus lock (R).

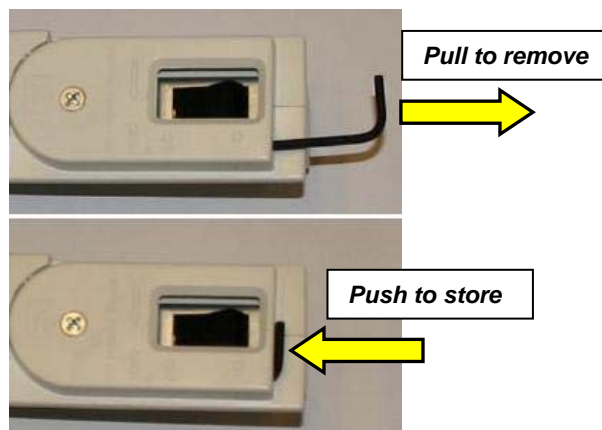

Figure 15. Allen key storage in fitting. Push in to secure the key.

CLEANING INSTRUCTIONS for LumeLEX 2000 REFLECTORS

Important

FOLLOW THESE INSTRUCTIONS SO TO PREVENT DAMAGE TO YOUR REFLECTOR. NOT CLEANING THE REFLECTOR CORRECTLY CAN REDUCE THE EFFICIENCY OF THE OPTICAL SURFACE. DO NOT TOUCH THE SURFACE OF THE REFLECTOR WITH YOUR BARE SKIN, AS HUMAN SKIN OIL WILL DEGRADE THE OPTICAL SURFACE.

Cleaning the Reflector

INSTRUCTIONS: Follow instructions from the specific fixture and reflector for removal and assembly of the reflector to that fixture. Wear blue nitrile gloves during this process to ensure not to touch the optical surface of the reflector with your bare skin.

MATERIALS REQUIRED:

- De-ionized water
- Blue Nitrile Gloves
- Dish soap (such as Dawn®) OR
- Can of clean compressed air OR
- Lens Tissue (such as Kemwipes®) OR
- Isopropyl Alcohol
- Air Bulb (aka suction bulb)
- Terry Cloth

STEP	ACTION
1	Remove the reflector from the fixture
2	Using either a can of clean compressed air or a bulb, blow clean air across to remove any surface dust or debris.
3	Apply a generous amount of either De-ionized water combined with a small amount of dish soap, or Isopropyl Alcohol, to a lens tissue or terry cloth.
4	While wearing nitrile gloves, gently clean the inside of the reflector with the wet lens tissue or terry cloth.
5	Allow optic to dry prior to reinstalling onto the fixture.