

LZ • 120/277V • LED • COB • CONTROLTrack COMPATIBLE



These compact spotlights offer zoom functionality to easily adjust beam spreads from 5° to 50°.

- Adjustable 5°- 50° optic produces up to 30,000 CBCP with 1850 lumens at 20 watts
- System efficiency up to 53 lumens/watt
- Exceeds ANSI specifications by maintaining extremely tight color consistency over the life of the fixture
- Tested to LM79 and LM80 Protocols
- 50,000 hour life to 70% lumen output, L₇₀ at 95°F max ambient
- Hidden integral electronic driver, compatible with various controls
- Color Rendering Index (CRI) 80, 90
- Color consistency, 2 MacAdam ellipses
- 0-10V dimming allows for 2 zones of control on one circuit CONTROLTrack down to 10%
- DMX compatible with dimming below 1%
- Removable accessory cartridge for any double combination of size-ZM LSI filters and accessories
- No UV or IR emissions; no mercury or lead
- On/off safety switch (on most mounting types)
- Sturdy die-cast aluminum housing
- Integrated latch on barrel to lock focus in place
- Horizontal and vertical aiming is both self and tool-locking via Allen key
- Finishes: LSI Black, White, and Silver
- Fixture weight: 4 lbs

FIXTURE PART NUMBERS

Please review the **ORDERING INFORMATION** section on the next page as well as the **MOUNTING OPTIONS** on page 3 to create a part number for each fixture that specifies the following:

- LED Module
- LED Rating
- Color Temperature
- Optic
- Fitting
- Dimming
- Voltage
- Finish

PART NUMBER

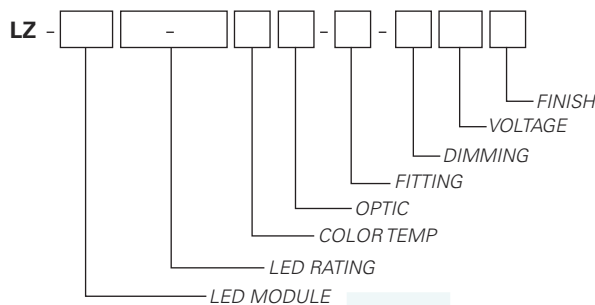

Example Part Number: **LZ-C0619-8030ZM-CT4-DX120W** is a fixture with a single LED module, 1850 Lumen/80 CRI/20 Watt LED rating, 3000°K Color Temperature, 6mm Adjustable Optic, CT4 CONTROLTrack fitting with DMX Address knobs and DMX compatible control gear, 120V and a White finish.

LZ • 120/277V • LED • COB • CONTROLTrack COMPATIBLE

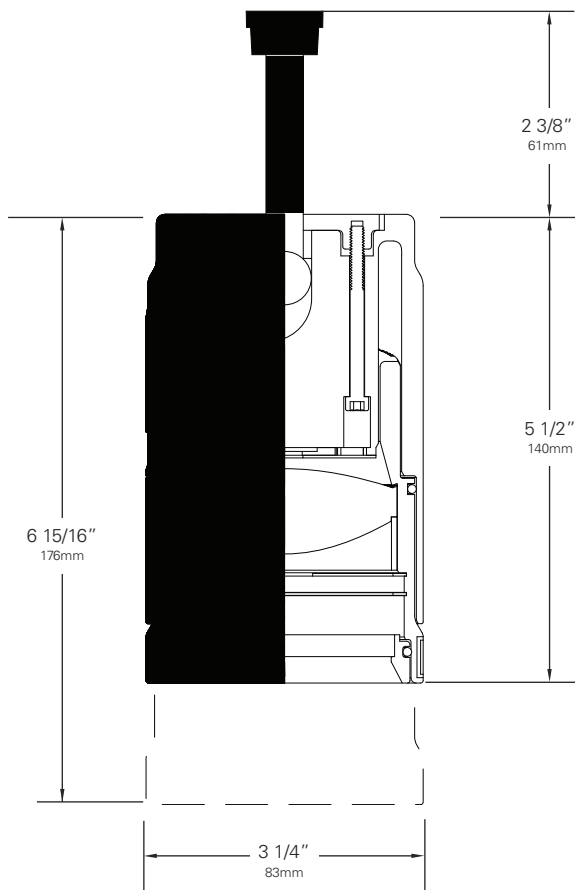

DRIVER TYPE (Electronic)

0-10V Dimmer

Input Power (A) - 120V	0.16
Input Power (A) - 277V	0.07
Wattage	20
Power Factor - 115V	0.92

DMX Dimmer

Input Power (A) - 120V	0.16
Input Power (A) - 277V	0.07
Wattage	20
Power Factor - 115V	0.92

LED ORDERING INFORMATION

Base Fixture Model

- LZ-C06 (6mm COB)

LED Rating (Lumens/CRI/Wattage)

- 19-80 = 1850/80/20
 15-90 = 1500/90/20

Color Temperature

- 27 = 2700K
 30 = 3000K
 35 = 3500K
 40 = 4000K

Optic

- ZM = 5° - 50° Adjustable Optic

Fitting/Controls (Dimming)

- CT2-10 = CONTROLTrack Fitting & 0-10V (10%)
 CT4-DX = CONTROLTrack Fitting & DMX (<1%)

Voltage

- 120 = 120V 230 = 220-240V 277 = 277V

Finish

- B = Black W = White S = Silver

Example Part Number:

LZ-C06 **19-80** **30** **ZM-CT4-DX** **120** **W**
FIXTURE MODEL LED RATING COLOR TEMP OPTIC FITTING/DIMMING VOLTAGE FINISH

Other Options (Consult Factory):

- Custom Stems, specify length (4" - 48")
- Custom Finish, RAL palette

LZ • MOUNTING OPTIONS

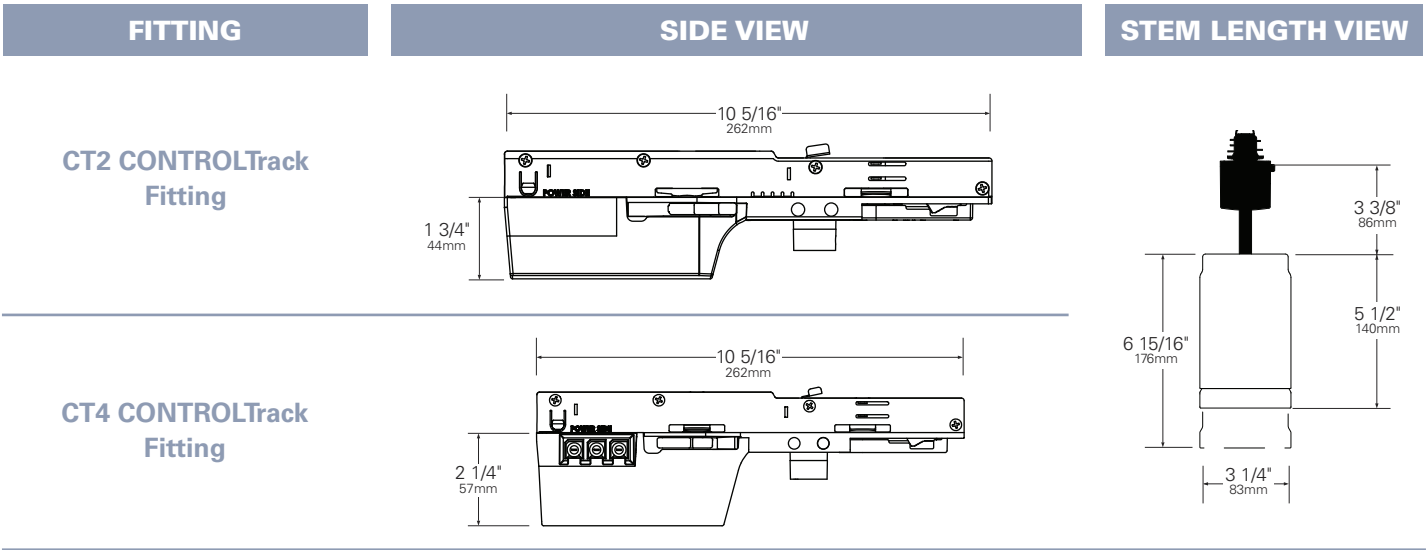

LZ • PERFORMANCE

The performance characteristics of the LZ Zoom family of products can be customized based on the LED module and the optic selected.

Each available LED module is defined by four characteristics – the color rendering index (CRI), the correlated color temperature (CCT), the power that it uses (watts), its “available lumens” and beam spread. Note that available lumens is a theoretical value that represents the light output of the module on its own – no fixture or optic attached.

In the LSI part number, the LED module is specified with a letter and a number that immediately follow the product series number. For example, in the part number LZ-C0619-8030ZM-CT4-DX120W, the “C0619-8030ZM” represents an LED module with an output of 1850 lumens, a CRI of 80, a power usage of 20 watts, color temperature of 3000K and a 5° - 50° adjustable degree beam.

Additional parameters, such as Center Beam Candle Power (CBCP), Delivered Lumens, and Efficiency (Lumens per Watt) are all shown in a table that is organized by LED module and optic combination.

CBCP = Center Beam Candle Power			
LED Module	Optic (Reflector)		
Lumens/CRI/Wattage	5°*	25°*	50°*
1850/80/20	30,000	4,500	1,500
1500/90/20	24,300	3,600	1,200

Delivered Lumens			
LED Module	Optic (Reflector)		
Lumens/CRI/Wattage	5°*	25°*	50°*
1850/80/20	440	660	1,050
1500/90/20	350	530	850

Efficiency = Lumens Per Watt			
LED Module	Optic (Reflector)		
Lumens/CRI/Wattage	5°*	25°*	50°*
1850/80/20	22	33	53
1500/90/20	18	27	43

*Preliminary Data

LED Module Lumens/CRI/Wattage SKU Code	1850/80/20 1500/90/20
Nominal Fixture Power (+/- 20%), Watts	20
Maximum Inrush Current Amps	10
Minimum Power Factor	0.92

Inrush current is instantaneous current drawn by the LED only when fixture is initially powered on or instantaneously changed from full dim to full bright. For more details see Dimming Application Sheet, IS-0119.

LZ • PHOTOMETRIC DATA

PHOTOMETRIC DATA

LZ Zoom Series

19-80 LED Rating

Beam Spread (minimum) **5°**
 Center Beam Candlepower **30000***
 CRI **80**

LZ Zoom Series

19-80 LED Rating

Beam Spread (minimum) **25°**
 Center Beam Candlepower **4500***
 CRI **80**

LZ Zoom Series

19-80 LED Rating

Beam Spread (minimum) **50°**
 Center Beam Candlepower **1500***
 CRI **80**

LZ Zoom Series

15-90 LED Rating

Beam Spread (minimum) **5°**
 Center Beam Candlepower **24300***
 CRI **90**

LZ Zoom Series

15-90 LED Rating

Beam Spread (minimum) **25°**
 Center Beam Candlepower **3600***
 CRI **90**

LZ Zoom Series

15-90 LED Rating

Beam Spread (minimum) **50°**
 Center Beam Candlepower **1200***
 CRI **90**

*Preliminary Data

LED Rating: 19-80

50°	25°	5°
1500	4500	30000
375	1125	7500
167	500	3333
94	281	1875
60	180	1200
42	125	833
31	92	612
23	70	469
19	56	370
15	45	300
12	37	248
10	31	208
9	27	178
8	23	153
7	20	133
6	18	117
5	16	104
5	14	93
4	12	83
4	11	75
3	10	68
3	9	62
3	9	57
3	8	52
2	7	48

All Distances in Feet

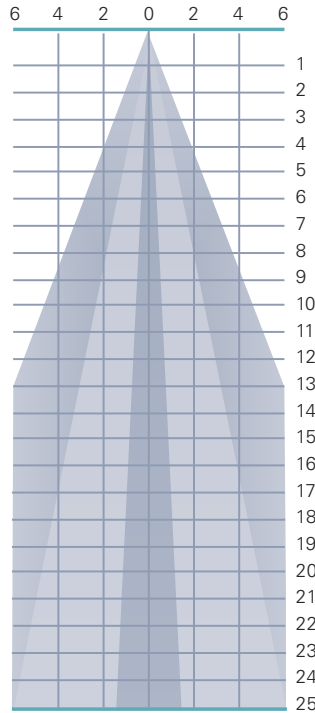

Photometric Data based on LED Rating: 19-80 (1850 Lumens/80CRI/20Watts)

LED Rating: 15-90

50°	25°	5°
1200	3600	24300
300	900	6075
133	400	2700
75	225	1519
48	144	972
33	100	675
24	73	496
19	56	380
15	44	300
12	36	243
10	30	201
8	25	169
7	21	144
6	18	124
5	16	108
5	14	95
4	12	84
4	11	75
3	10	67
3	9	61
3	8	55
2	7	50
2	7	46
2	6	42
2	6	39

All Distances in Feet

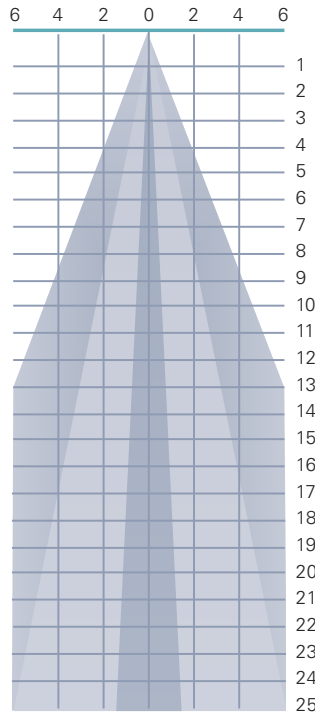

LZ • ACCESSORIES



LOUVER HEX ZM

1/8" thick Hexcell black metal louver used for thin profile.

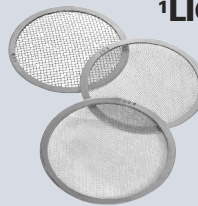

¹LIGHT BLOCKING SCREENS ZM

Stainless steel mesh screens used alone or in combinations will block from approximately 20% to 90% of the transmitted light without changing color temperature of the light.

No.	% of Light Blocked
ZM801S	20
ZM802S	30
ZM803S	40

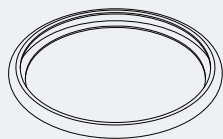

BACKER RING ZM

Aluminum ring to hold thin film gels when no other size ZM accessories are being used.

1. Figures vary based upon LED module/optic being used and relationship of screen(s) to LED module/optic and to each other.

LZ • GELS

As the foremost innovator in accent lighting, LSI offers a complete range of pre-cut Gels to modify the spread and color of light for the LumeLEX LED Series.



LumeLEX® SPREAD GELS

Size: ZM (71 mm diameter)	Spread Gel
GEL-L1-ZM	1° Spread Gel
GEL-L5-ZM	5° Spread Gel
GEL-L10-ZM	10° Spread Gel
GEL-L20-ZM	20° Spread Gel
GEL-L30-ZM	30° Spread Gel
GEL-L40-ZM	40° Spread Gel
GEL-L60-ZM	60° Spread Gel
GEL-L80-ZM	80° Spread Gel
GEL-L30B5-ZM	30° by 5° Spread Gel
GEL-L40B2-ZM	40° by 0.2° Spread Gel
GEL-L60B1-ZM	60° by 1° Spread Gel
GEL-L60B10-ZM	60° by 10° Spread Gel
GEL-L75B45-ZM	75° by 45° Spread Gel
GEL-L90B60-ZM	90° by 60° Spread Gel
GEL-R101-ZM	Beam Softener

LumeLEX® COLOR GELS

Size: ZM (71 mm diameter)	Gel Color	% of Light Transmission	Size: ZM (71 mm diameter)	Gel Color	% of Light Transmission
GEL-R2-ZM	Bastard Amber	78	GEL-R312-ZM	Canary	85
GEL-R7-ZM	Pale Yellow	96	GEL-R3204-ZM	Half Blue	52
GEL-R12-ZM	Straw	88	GEL-R331-ZM	Shell Pink	68
GEL-R13-ZM	Straw Tint	78	GEL-R383-ZM	Sapphire Blue	4
GEL-R14-ZM	Medium Straw	68	GEL-R397-ZM	Pale Grey	70
GEL-R21-ZM	Golden Amber	43	GEL-R2001-ZM	Storaro Red	12
GEL-R25-ZM	Orange Red	14	GEL-R2004-ZM	Storaro Green	15
GEL-R26-ZM	Light Red	12	GEL-R2009-ZM	Storaro Violet	3
GEL-R27-ZM	Medium Red	4	GEL-R3202-ZM	Full Blue	36
GEL-R57-ZM	Lavender	24	GEL-R3206-ZM	Third Blue	64
GEL-R62-ZM	Booster Blue	54	GEL-R3216-ZM	Eighth Blue (Boosts 3200K to 3300K)	81
GEL-R71-ZM	Sea Blue	30	GEL-R3318-ZM	Tough 1/8 Minusgreen	89
GEL-R72-ZM	Azure Blue	44	GEL-R3410-ZM	Roscocosun (1/8 CTO) (Reduces 5500K to 4900K)	92
GEL-R91-ZM	Primary Green	7	GEL-R3441-ZM	Full Straw (CTS)	50
GEL-R97-ZM	Light Grey	50	GEL-R3443-ZM	Quarter Straw (CTS)	81
GEL-R98-ZM	Medium Grey	25	GEL-R4330-ZM	CalColor 30 Cyan	63
GEL-R101-ZM	Light Frost	N/A	GEL-R4415-ZM	CalColor 15 Green	67
GEL-R104-ZM	Tough Silk	N/A	GEL-R4490-ZM	CalColor 90 Green	25
GEL-R119-ZM	Lt. Hamburg Frost	N/A	GEL-R4860-ZM	CalColor 60 Pink	46
GEL-R121-ZM	Blue Diffusion	N/A	GEL-R4890-ZM	CalColor 90 Pink	38
GEL-R305-ZM	Rose Gold	75	GEL-R4930-ZM	CalColor 30 Lavender	47

* Backer Ring ZM required to hold gels when no other rimmed "ZM" accessories are used.

LSI ROSCO GEL CCT CONVERSION CHART FROM 3000K			
Type	ROSCO #	ROSCO Description	Resulting CCT
Amber Filters Lower CCT	3420	Double CTO	1531
	3407	Sun CTO	1999
	3401	Sun 85	2154
	3411	Sun 3/4 CTO	2154
	3408	Sun 1/2 CTO	2414
	3409	Sun 1/4 CTO	2664
	3410	Sun 1/8 CTO	2830
	3114	UV Filter	2930
Blue Filters Raise CCT	3220	Double Blue	N/A
	3202	Full Blue	4942
	3203	Three-Quarter Blue	4286
	3204	Half Blue	3769
	3206	Third Blue	3517
	3208	Quarter Blue	3297
	3216	Eighth Blue	3112

COLOR MEDIA

COLOR FILTERS

As the foremost innovator in accent lighting, LSI offers a complete range of permanent fade-free glass color filters, which are available in nine stock diameters. All glass color filters are rimmed in a seamless aluminum ring and are slotted for heat expansion.

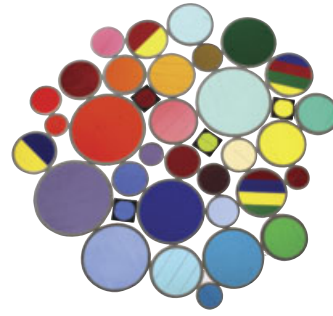

Size	Diameter	LSI Fixture Series	No.	Color	% of Light Transmission
AAA	2 3/8"	LumeLEX® 2020/2030/2031/2038, SSLCX16, SSL260, LumeLEX MAR-S	902	Medium Pink	36
			903	Deep Pink	37
			904	Flesh Pink	73
ZM	2 13/16"	LZ Zoom	906	Pale Lavender	14
			907	Surprise Pink	19
AA	3"	LumeLEX® 2024 (with LX2024-Holder or LX2024-Barndoor), LumeLEX® 2044, LumeLEX 2048	908	Lilac	21
			910	Warm Red	10
			911	Strawberry	6
			912	Ruby	4
A	3 1/2"	LumeLEX® 2060, SSL230, SSLCX30, SSLGR30CL, SSLGR36	913	Magenta	1
			914	Light Amethyst	25
B	4 1/4"	LumeLEX® MAR-L	915	Medium Amethyst	16
			916	Deep Amethyst	4
			917	Olive	18
C	4 3/4"	LumeLEX® 2084, LumeLEX® 2088, SSL238, SSLCX36, SSLCX38, SSLGR38CL	918	Light Green	68
			920	Medium Green	25
			921	Deep Green	7
			922	Silver green	65
			923	Yellow Green	49
			924	Emerald Green	12
			925	Light Turquoise	68
			926	Medium Turquoise	40
			927	Deep Turquoise	17
			928	Light Blue	34
			930	Medium Blue	3
			932	Daylight	59
			933	Gene Moore Blue	18
			936	Grey	56
			937	Light Blue Green	17
			939	Light Amber	68
			940	Medium Amber	48
			941	Deep Amber	43
			942	Straw	78
			943	Gold	87
			944	Canary Yellow	84
			945	Lemon	81
			946	Pumpkin	32
			947	Tangerine	20
			948	Orange	23
			949	Pink Gold	54
			950	Bronze	48
			951	Brass	11
			952	Autumn Tan	11
			953	Leaf Brown	19
			954	Butter Pecan	3
			955	Toasted Almond	1

Notes:

1. Values given are approximate due to slight variations in glass color and thickness.

COLOR MEDIA

DICHROIC COLOR FILTERS

In addition to our complete line of glass color filters, LSI now offers dichroic glass color filters that achieve purer, more saturated, richer color by selective wavelength transmission. Since these filters reflect rather than absorb the unwanted color wavelengths, a higher intensity of colored light can be obtained with fewer or lower wattage fixtures. In addition, this selective transmission allows for very accurate color matching from filter to filter.

All standard LSI filter sizes are available in a wide palette of well chosen dichroic colors that can be used with all LSI fixtures that accept accessories.

LSI dichroic glass color filters have the added benefit of being rimmed for extra durability to allow for frequent usage without fear of breakage or edge chipping.

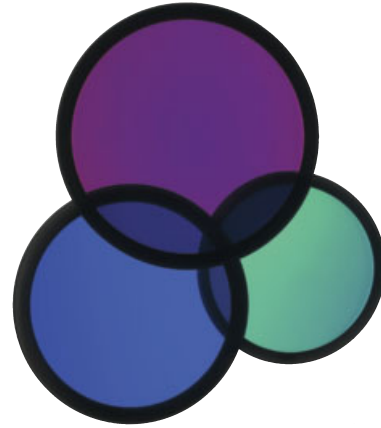

Size	Diameter	LSI Fixture Series	Technical Data	No.	Color	% of Light Transmission
AAA	2 3/8"	LumeLEX® 2020/2030/2031/2038, SSLCX16, SSL260, LumeLEX MAR-S	Dichroic color filters are created in a vacuum chamber by multi-layer vapor deposits of different minerals onto low expansion, chemically resistant Borosilicate glass.	2001	Light Pink	69
ZM	2 13/16"	LZ Zoom	Deposits are made in alternating layers of varying microscopic thickness which allow very narrow color wavelengths to be selectively transmitted and all other wavelengths to be reflected.	2002	Medium Pink	43
AA	3"	LumeLEX® 2024 (with LX2024-Holder or LX2024-Barndoor), LumeLEX® 2044, LumeLEX 2048	LSI does not recommend using dichroic color filters with lamps or fixtures that have beam spreads greater than 40° because a secondary color aura is created by the wide angular transmitted wavelengths that are different than the desired color wavelength.	2003	Hot Pink	11
A	3 1/2"	LumeLEX® 2060, SSL230, SSLCX30, SSLGR30CL, SSLGR36	Since there is mainly transmission and reflection of the color wavelengths by the dichroic filter and very little absorption, the dichroic filter can be used with many high temperature lights that normally would not accept color filters.	2004	Pale Pink	55
B	4 1/4"	LumeLEX® MAR-L		2010	Deep Magenta	29
C	4 3/4"	LumeLEX® 2084, LumeLEX® 2088, SSL238, SSLCX36, SSLCX38, SSLGR38CL		2011	Lavender	24
				2012	Vivid Magenta	31
				2013	Lavender Accent	48
				2014	Lilac	37
				2015	Purple Fusion	12
				2020	Sky Blue	39
				2021	Sea Blue	39
				2022	Cyan	33
				2023	Light Blue Green	30
				2024	Primary Blue	24
				2025	Medium Red Blue	15
				2026	Deep Purple	16
				2027	Peacock Blue	53
				2028	Mediterranean Blue	20
				2029	Boost Blue	51
				2040	Light Yellow Green	64
				2041	Fern Green	47
				2042	Turquoise	35
				2043	Primary Green	31
				2044	Industrial Green	64
				2050	Yellow	80
				2051	Amber	71
				2052	Amber Blush	38
				2053	Bastard Amber	71
				2054	Goldenrod	63
				2055	Bright Straw	56
				2060	Medium Orange	51
				2061	Orange	44
				2070	Flame Red	27
				2071	Primary Red	25